

Pistons 3 <sup>10</sup>/<sub>10</sub>  
Rings 6-30  
Postage .50

6 <sup>20</sup>/<sub>10</sub>  
180

Part No. 27-300770

1 " 27-247-1495-30  
and KA-37

# REPAIR PARTS CATALOG

For

Models KA-38, 39, 10,  
KS and KD-15

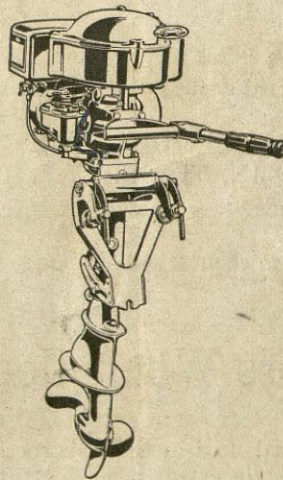

## JOHNSON MOTORS

Waukegan, Illinois, U. S. A.

All Prices Subject to Change Without Notice.

## HOW TO ORDER PARTS

- 1st. Give MOTOR NUMBER and Model, which will be found on cover plate on flywheel.
- 2nd. Look in list for part number which will show name and price per piece.
- 3rd. Write order plainly, giving the motor number, part number, name of part and price per piece.
- 4th. Show to whom parts are to be shipped.
- 5th. To insure quick service, ALWAYS INCLUDE REMITTANCE WITH POSTAGE TO COVER CARRYING CHARGES AND INSURANCE. Stamps are accepted as cash up to 25 cents. A minimum charge of 25c will be made on all orders amounting to less than that amount. All parts shipped insured at a charge of 5 cents extra.

### IMPORTANT :

No replacements made unless regular claim is entered on form provided for that purpose by all authorized dealers or service stations.

ALL DEFECTIVE PARTS MUST BE RETURNED WITH CLAIM FORM PROPERLY FILLED IN, TRANSPORTATION PREPAID, before any replacements will be made. (See inside back cover for service stations.)

All prices are subject to change without notice.

## Care of Motors When Used in Salt Water

Regardless of the material used in the construction of an outboard motor, it will corrode and tarnish to a certain extent when used in salt water. It is of importance, therefore, to adhere closely to the following instructions if you want to receive the most from your motor.

1. Remove the motor from the boat when it is not in service.
2. Flush out the cooling system by running motor in a barrel of fresh water.
3. Rinse off thoroughly with fresh water.
4. Wipe dry with a cloth.
5. Go over all the bright parts with an oily cloth, especially if the motor is to be stored for any length of time.

# WARRANTY

All Johnson Motors (racing models excepted) are warranted to be free from defects in material and workmanship under normal use and service, our obligation under this Warranty being limited to making good at our factory in Waukegan, Illinois, any part or parts thereof which shall, within three months after date of delivery to owner, be returned to us with transportation charges prepaid, and which our examination shall disclose to our satisfaction to have been thus defective, this warranty being expressly in lieu of all other warranties and representations, express or implied, and of all other liabilities in connection with the sale or use of our outboard motors.

This Warranty shall not apply to any outboard motor which shall have been repaired or altered outside of the factory in any way so as, in our judgment, to affect its stability or reliability, nor which has been subject to misuse, negligence or accident.

## Claims Must Be Entered On All Returned Goods

Regular claim forms are provided all our dealers, service stations and distributors. All claims must be entered on this form, No. SE-16, before parts are returned to factory. No part will be replaced unless this form is used. See your dealer for claim form.

All material — motors or parts — be returned to your nearest service station or direct to factory **TRANSPORTATION CHARGES PREPAID**. See inside back page for list of service stations.

**REMEMBER — ALWAYS** request a claim form and properly fill it in before returning any material to our service station or direct to factory.

## Warranty Does Not Apply To Racing Motors

Due to the excessive strains and stresses placed upon motors when used for racing, all Johnson motors of racing model or all other models when used for racing are sold with the distinct understanding that they are not guaranteed in any manner, and the Johnson Motor Company does not assume any responsibility for injury or damage sustained from their use thereof.

**All Prices Are Subject To Change Without Notice**

Always Give Part Number and Motor Number

**KA-38, -39, -10, KS and KD-15 POWER HEAD**

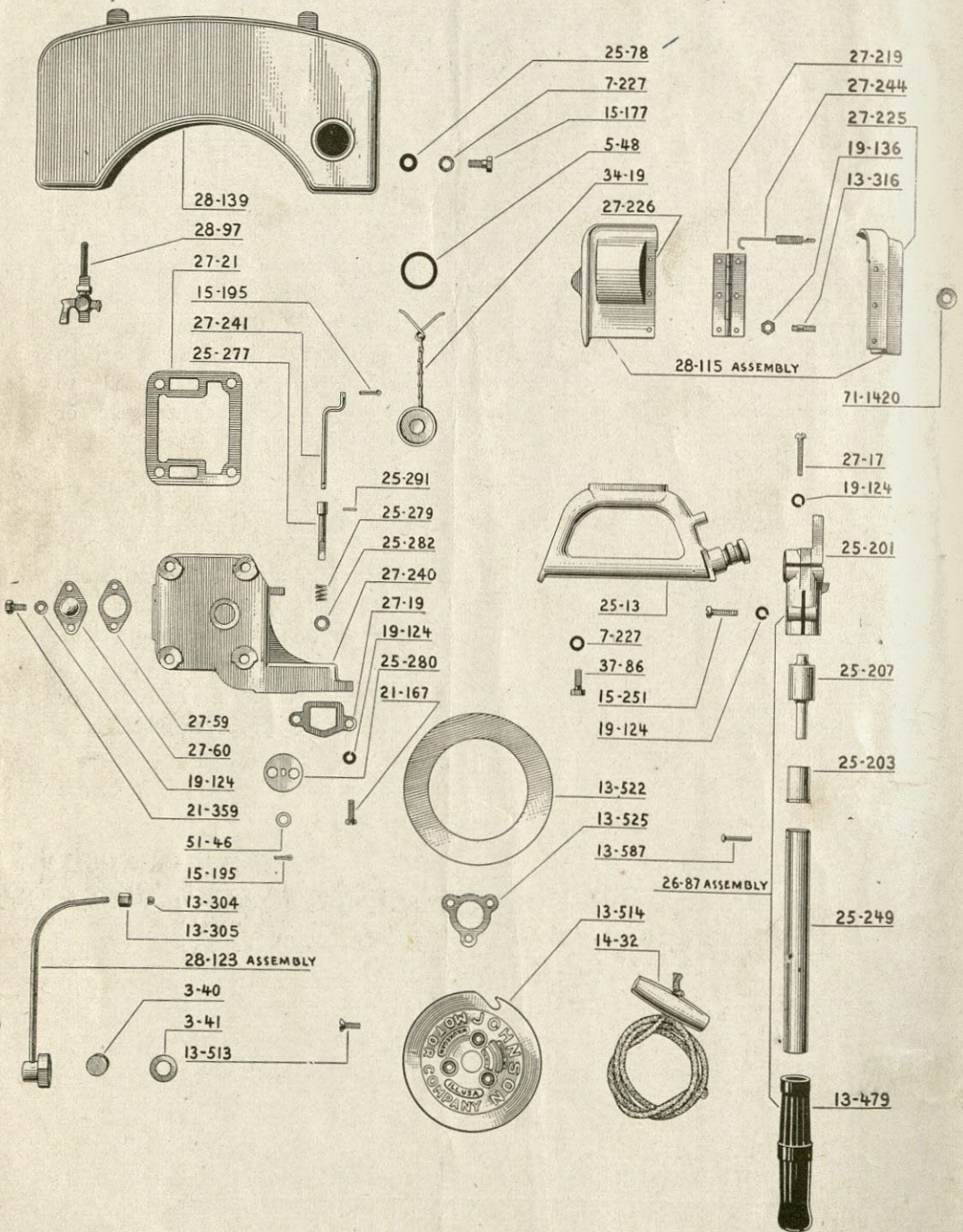

Order All Parts from Nearest Dealer or Service Station

KS-15  
#401043

Always Give Part Number and Motor Number

### KA-38, -39, -10, KS and KD-15 POWER HEAD

Ex main 276240  
carb. ass. 270255  
M. Block 2761-13  
C-Rod - 27B820

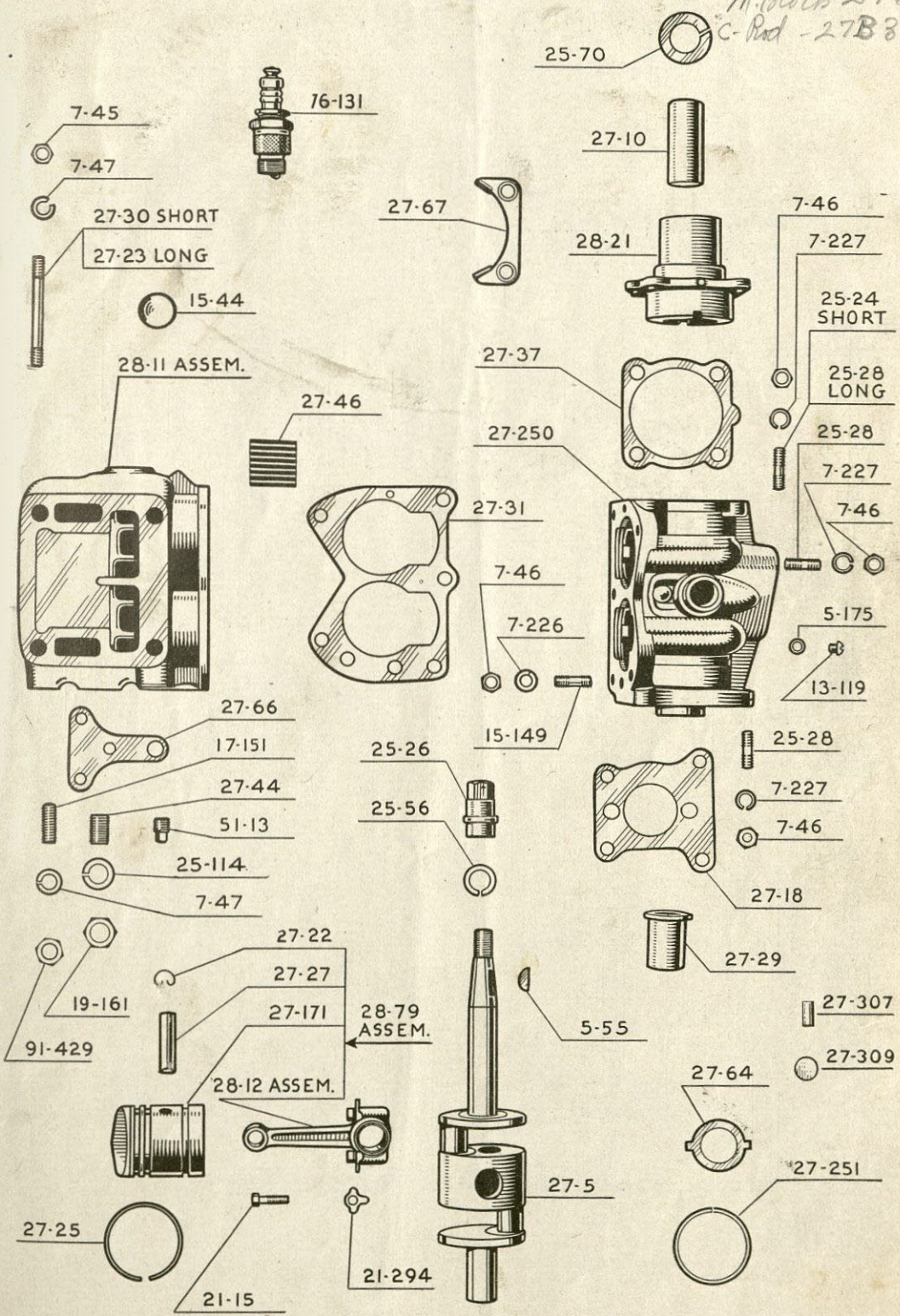

Always Give Part Number and Motor Number



Always Give Part Number and Motor Number

**MOTOR PARTS FOR MODEL KA-38, 39, -10 KS and KD-15**

Part No.	No. Required per Motor	NAME OF PART	Code Word	List Price per Piece
1-139	8	Rivet for Hinge.....	JAQFJ	.05
3-37	1	Nut - Settling Basin.....	JACEF	.25
3-40	1	Screen for Strainer.....	JACEM	.05
3-41	1	Gasket for Strainer.....	JACEP	.05
5-48	1	Gasket for Filler Cap.....	JADRA	.05
5-55	2	Key for Crankshaft.....	JADRI	.05
5-58	1	Lock Washer for Tilting Shaft.....	JADSI	.025
5-175	1	Washer for Oil Line Cleanout.....	JACFI	.025
7-31	1	Screw for Pilot Band.....	JAPCD	.05
7-45	2	Nut - Driveshaft Casing to Gearcase Stud - Muffler Stud.....	JAPCL	.025
7-46	12	Nut - Crankcase to Crankcase Head - Cylinder to Crankcase - Driveshaft to Crankcase.....	JAPCM	.025
7-47	3	Lockwasher - Driveshaft Casing to Gearcase Stud - Steering Eye Stud.....	JAPCN	.025
7-227	11	Lockwasher - Crankcase Head Stud - Steering Rail and Driveshaft Casing to Crankcase - Gas Tank Screw.....	JAPEM	.025
11-66	1	Straight Fitting for Oil Line.....	JARIG	.10
13-51	6	Lockwasher for Swivel Bracket and Pilot Band Screw.....	JACOP	.025
13-84	1	Pin - Driveshaft to Coupling.....	JADAY	.05
13-119	1	Screw - Oil Line Cleanout.....	JACEW	.05
13-304	1	Gland for Gas Line.....	JAMBF	.025
13-305	1	Nut for Oil Line.....	JAMBG	.05
13-306	2	Gland for Oil Line.....	JAMAR	.025
13-307	2	Nut for Oil Line.....	JAMAS	.025
*13-316	2	Stud for Spark Plug Cover (Not used on KA-39).....	JAFMO	.05
13-479	1	Grip for Steering Handle.....	JANBP	.15
13-513	3	Screw for Cover Plate.....	JAPXY	.05
13-514	1	Cover Plate.....	JAPXZ	1.70
13-522	1	Cover for Inspection Hole.....	JAQBI	.50
13-525	1	Gasket for Cover Plate.....	JAPYY	.05
13-542	1	Plug for Driveshaft Casing.....	JANAB	.05
*13-585	2	Washer - Spark Plug Cover Studs (Not used on KA-39).....	JAPYL	.025
13-587	1	Rivet for Steering Handle Tube.....	JARAH	.025
15-44	2	Core Plug - Cylinder.....	JAPKZ	.05
15-56	4	Rivet for Quadrant.....	JAPLJ	.025
15-59	4	Rivet for Thrust Socket Lining.....	JAPLM	.025
15-61	1	Washer for Thrust Socket Bolt.....	JAPLO	.05
15-62	1	Nut for Thrust Socket Bolt.....	JAPLP	.15
15-83	1	Retainer for Bevel Pinion.....	JAPMH	.10
15-84	1	Cotter Pin.....	JAPMI	.025
15-92	1	Key - Bevel Gear.....	JAPMP	.05
15-101	1	Nut for Propeller.....	JAPMX	.30
15-102	1	Shear Pin for Propeller.....	JAPMY	.025
15-149	5	Stud - Cylinder to Crankcase.....	JAPRR	.05
15-155	1	Pin for Bevel Pinion.....	JAPRU	.10
15-177	1	Screw - Gas Tank to Cylinder.....	JAPSW	.05
15-195	3	Cotter Pin - Cutout Retainer Link.....	JAPTV	.025
17-151	1	Stud for Steering Plate.....	JAPUZ	.05
17-211	2	Spacer - Condenser to Control Plate.....	JAQBQ	.025
17-216	1	Nut - Crankcase Head to Crankcase.....	JAQBT	.025
19-51	2	Core Plug - Driveshaft Casing.....	JAQGJ	.025
*19-124	8	Lockwasher - Muffler to Driveshaft Casing Screw - Clamp Screw - Plug Cover and Exhaust Cutout Cap (6 only used on KA-39 - not used on spark plug cover KA-39).....	JAQDK	.025
19-130	1	Washer for Tilting Shaft.....	JASPG	.025
*19-136	2	Nut - Spark Plug Cover (Not used on KA-39).....	JAQGN	.025
19-161	1	Nut for Pipe Stud.....	JAQGO	.05

\*Refers to KA-39 parts that differ in quantity or Part No. from those used on KA-38.

**Order All Parts from Nearest Dealer or Service Station**

**Always Give Part Number and Motor Number**

**MOTOR PARTS FOR MODEL KA-38, -39, -10, KS- and KD-15—Cont.**

Part No.	No. Required per Motor	NAME OF PART	Code Word	List Price per Piece
21-15	4	Screw - Connecting Rod.....	JAQHB	.15
21-120	1	Lock Plate - Propeller Shaft Lock Nut.....	JAQKL	.05
21-124	1	Screw - Bushing Clamp.....	JAQRW	.05
21-154	4	Plain Washer for Muffler Stud.....	JAQKZ	.025
*21-167	2	Screw - Muffler to Driveshaft Casing (4 used on KA-39) (2 Muffler to Driveshaft Casings and 2 Spark Plug Covers used on KA-39).....	JAQLJ	.025
21-294	4	Lock Plate for Connecting Rod Screws.....	JAQOB	.025
21-359	2	Screw for Exhaust Cutout Cap.....	JARAL	.025
21-592	1	Washer - Lock Plate.....	JAWHZ	.025
25-13	1	Steering Rail.....	JARAU	3.00
25-24	2	Stud - Crankcase Head to Crankcase—Short.....	JARBD	.05
25-26	1	Nut for Crankshaft.....	JARBF	.40
25-28	2	Stud - Crankcase to Crankcase Head—Long - Crankcase to Driveshaft Casing.....	JARBH	.05
25-39	1	Coupling - Driveshaft.....	JARBQ	.50
25-44	2	Stud - Gearcase to Driveshaft Casing.....	JARBT	.25
25-45	2	Stud - Driveshaft Casing to Crankcase.....	JARBU	.05
25-56	1	Lockwasher for Crankshaft Nut.....	JARCC	.025
25-57	1	Plain Washer for Crankshaft Nut.....	JARCD	.025
25-70	1	Oil Slinger.....	JARCN	.30
25-78	1	Spacer - Gasoline Tank Support.....	JARCQ	.05
25-114	1	Lockwasher for Pipe Stud Nut.....	JARCB	.025
25-127	1	Pipe Plug - Driveshaft Casing.....	JAUYJ	.15
25-201	1	Lever for Steering Handle.....	JAWEH	2.00
25-203	1	Bushing - Steering Handle.....	JAWAC	.25
25-207	1	Rubber Bushing for Steering Handle.....	JAWAD	1.50
25-217	1	Bushing for Pilot.....	JAWEM	.25
25-242	4	Screw for Swivel Bracket.....	JAWEV	.025
25-249	1	Tube for Steering Handle.....	JAWEW	.45
25-250	1	Pin for Pilot Spring.....	JAWEX	.05
25-267	1	Bracket for Carburetor Control Link.....	JAWYT	.05
25-277	1	Cutout Shaft.....	JAWYU	.50
25-279	1	Spring for Muffler Cutout.....	JAWYV	.05
25-280	1	Disc for Cutout.....	JAWYW	.15
25-281	2	Shoulder Screw for Carburetor Control.....	JAWYX	.05
25-282	1	Washer for Cutout Spring Retainer.....	JAWYY	.025
25-283	1	Rivet - Link to Bracket.....	JAWYZ	.025
25-291	1	Groove Pin.....	JAXDD	.025
27-5	1	Crankshaft.....	JARFQ	19.50
27-10	1	Journal Bearing - Upper.....	JARFU	1.70
27-15	2	Quadrant for Stern Bracket.....	JARFV	.85
27-17	1	Steering Handle Clamp Screw.....	JARIK	.025
27-18	1	Gasket - Driveshaft Casing to Crankcase.....	JARFX	.05
27-19	1	Gasket - Muffler to Driveshaft Casing.....	JARFY	.05
27-21	1	Gasket - Muffler to Cylinder.....	JARFZ	.10
27-22	4	Lock Ring for Piston Pin.....	JARGA	.05
27-23	2	Stud - Muffler to Cylinder - Long.....	JARGB	.10
27-25	6	Piston Ring.....	JARGC	.25
27-27	2	Piston Pin.....	JARGE	.30
27-29	1	Journal Bearing - Lower.....	JARGF	1.00
27-30	2	Stud - Muffler to Cylinder - Short.....	JARGG	.10
27-31	1	Gasket - Cylinder Base.....	JARGH	.05
27-32	1	Thrust Washer for Pinion Shaft.....	JARGI	.15
27-36	2	Thrust Washer for Swivel Bracket.....	JARGM	.20
27-37	1	Gasket - Crankcase Head to Crankcase.....	JARGN	.05
27-44	1	Pipe Stud to Cylinder.....	JARGS	.15
27-48	1	Lining for Thrust Socket.....	JARGU	.60
27-49	1	Gasket - Gearcase to Driveshaft Casing.....	JARGV	.05
27-59	1	Gasket for Cutout Cap.....	JARCT	.05
27-60	1	Cap for Exhaust Cutout.....	JARCU	.40
27-61	1	Shim - Upper Journal .003.....	JARGZ	.025
27-63	1	Shim - Upper Journal .010.....	JARHB	.025
27-64	1	Thrust Washer for Crankshaft.....	JARHC	.25

\*Refers to KA-39 parts that differ in quantity or Part No. from those used on KA-38.

**Order All Parts from Nearest Dealer or Service Station**



Always Give Part Number and Motor Number

**MOTOR PARTS FOR MODEL KA-38, 39, -10 KS and KD-15**

Part No.	No. Required per Motor	NAME OF PART	Code Word	List Price per Piece
27-66	1	Plate for Steering Control.....	JARJR	.65
*27-67	1	Stop Bracket - (Not used on KA-39).....	JARHD	.10
*27-329	1	Stop Bracket - (Used on KA-39).....	JAZBI	.15
27-81	1	Shim - Upper Journal .002.....	JAVAJ	.05
27-82	1	Gasket - Steering Plate to Crankcase.....	JARIO	.05
27-83	1	Plate for Steering Plate to Crankcase.....	JARIN	.05
27-85	1	Oil Line.....	JARIV	.10
27-88	1	Elbow for Oil Line.....	JARIW	.15
27-171	2	Piston (Order 28-375.078).....	JAVXF	3.25
27-182	2	Thrust Washer for Stern Bracket.....	JAWGD	.05
27-196	1	Cap for Propeller Shaft Bearing.....	JAWGG	.05
27-197	1	Cork for Propeller Shaft Bearing.....	JAWGH	.05
27-199	2	Bushing for Swivel Bracket.....	JAWGJ	.05
27-212	1	Stern Bracket Casting Only.....	JAYHF	7.90
27-219	1	Hinge for Cover (Not used on KA-39, 10 or KS and KD)	JAWZA	.30
27-220	1	Bevel Pinion Gear.....	JAWGP	3.00
*27-225	1	Cover for Spark Plug - Front Half (Not used on KA-39).....	JAWZB	.55
*27-226	1	Cover for Spark Plug - Rear Half (Not used on KA-39).....	JAWZC	1.10
27-227	1	Transfer for Gas Tank.....	JAWZD	Net .15
27-240	1	Muffler.....	JAWZG	9.75
27-241	1	Crank Rod for Cutout Control.....	JAWZH	.30
27-242	1	Link for Cutout Control.....	JAWZI	.10
*27-244	1	Spring for Spark Plug Cover (KA-38 Only).....	JAXDC	.15
27-250	1	Crankcase - Less Bearings.....	JAXJT	17.75
27-251	2	Ring - Crankcase Seal.....	JAXJU	.35
27-275	1	Propeller.....	JAXQP	7.50
27-276	1	Bearing - Upper Pinion Shaft.....	JAXPT	.60
27-277	1	Bearing - Lower Pinion Shaft.....	JAXPU	.80
27-278	1	Gasket - Gearcase Head.....	JAXPV	.05
27-279	1	Bevel Gear.....	JAXPW	3.25
27-280	1	Propeller Shaft.....	JAXPX	4.00
27-281	1	Pinion Shaft.....	JAXPY	2.50
27-282	1	Bearing - Gearcase Head.....	JAXPZ	.75
27-283	2	Plug - Grease Holes.....	JAXQA	.20
27-284	2	Washer - Grease Plug.....	JAXQB	.025
27-286	1	Thrust Washer - Pinion Gear.....	JAXQD	.25
27-287	1	Spacer - Propeller Shaft.....	JAXQE	.35
27-288	1	Shim - Propeller Shaft .002.....	JAXQF	.025
27-289	1	Shim - Propeller Shaft .005.....	JAXQG	.025
27-290	1	Shim - Propeller Shaft .010.....	JAXQH	.025
27-291	1	Gearcase Casting Only.....	JAXQI	16.50
27-295	1 to 3	Shim - Lower Pinion Shaft Bearing.....	JAYHG	.05
27-298	2	Swivel Plate.....	JAYHD	.05
27-304	1	Link - Carburetor Control.....	JAYHH	.20
27-307	1	Drain Nipple - Crankcase.....	JAYHI	.05
27-308	1	Gland Nut - Drain Pipe.....	JAYHJ	.05
27-309	1	Plug - Drain Crankcase.....	JAYHK	.05
27-312	1	Clip - Drain Pipe.....	JAYHL	.025
27-313	1	Drain Pipe.....	JAYHM	.10
27-322	4	Screw for Connecting Rod - KA-39, 10, KS and KD-15	JEBOJ	.15
*27-326	1	Spark Plug Cover (Used on KA-39, 10, KS and KD).....	JAZAZ	.95
*27-327	1	Cylinder Cover (Used on KA-39, 10, KS and KD).....	JAZBA	1.40
*27-328	1	Screw Cylinder Cover (Used on KA-39, 10, KS and KD)	JAZBB	.20
27-300363	1	Spray Guard.....	JEBOK	.40
33-76	3	Screw - Gearcase Head.....	JATDJ	.05
37-64	1	Nut for Tilting Shaft.....	JAWAT	.10
37-86	3	Screw - Steering Rail to Crankcase.....	JAWCV	.025
39-17	3	Lockwasher - Gearcase Head Screw.....	JAXAP	.025
39-60	1	Lockwasher for Propeller Nut.....	JAWSV	.05
41-58	2	Spring - Pilot Band.....	JAXRV	.025
43-128	1	Feeler Gauge.....	JAYHN	.10
*43-300	3	Snap Ring - Cylinder and Spark Plug Cover Screw.....	JAZCA	.025

\* Refers to KA-39 -10, KS & KD parts that differ in quantity or Part No. from those used on KA-38.

**Order All Parts from Nearest Dealer or Service Station**

Always Give Part Number and Motor Number

**MOTOR PARTS FOR MODELS KA-38, -39, -10, KS and KD-15**

Part No.	No. Required per Motor	NAME OF PART	Code Word	List Price per Piece
51-13	1	Pipe Plug .....	JAQOO	.05
51-115	5	Lockwasher - Cylinder Base.....	JATIA	.025
71-1420	2	Grommet - High Tension Lead.....	JAWEY	.05
91-429	1	Nut for Steering Plate.....	JARJI	.05
<b>MOTOR ASSEMBLIES</b>				
14-32	1	Starting Rope .....	JAEDU	.15
26-87	1	Steering Handle Complete.....	JAWFE	5.00
26-91	1	Pilot Band Assembly.....	JAWGR	1.60
28-18	1	Driveshaft .....	JARHQ	2.25
28-20	1	Tool Kit .....	JARHR	2.25
28-21	1	Crankcase Head with Bearing.....	JARHS	5.50
28-25	1	Thrust Socket .....	JARHV	2.00
28-37	1	Driveshaft Casing .....	JARGX	17.50
28-40	1	Oil Line .....	JARIX	.35
28-53	1	Ball Bearing - Propeller Shaft - Front.....	JAVCL	2.80
28-79	2	Piston and Connecting Rod.....	JAWXS	7.25
28-93	1	Tilting Shaft .....	JAWGT	.45
28-94	1	Swivel Bracket .....	JAWXT	6.75
28-95	1	Stern Bracket with Quadrants and Clamp Screws Only.....	JAWGU	10.85
28-97	1	Shut-off Valve.....	JAWGS	.95
28-98	1	Stern Bracket Complete .....	JAWGW	16.50
28-102	1	Swivel Bracket and Pilot Band.....	JAWGX	9.50
28-106	1	Thrust Socket Bolt.....	JAWGY	.75
*28-115	1	Spark Plug Cover (Not used on KA-39, 10, KS or KD)	JAWXW	2.50
*28-116	1	Cylinder (Used on KA-39, KA-10, KS and KD-15).....	JAZBJ	15.00
28-139	1	Gasoline Tank with Transfer.....	JAXJY	19.50
28-156	1	Gearcase Head with Bearing.....	JAXQJ	3.00
28-157	1	Gearcase - Less Head - with Bearings Reamed.....	JAXQK	25.75
28-158	1	Gearcase Assembly Complete with All Gears, Shafts, and Bearings .....	JAXQL	52.50
28-159	1	Gearcase and Head Only - with Bearings Reamed.....	JAXQM	28.75
28-162	1	Lower Unit Complete - Less Propeller.....	JAXQN	75.00
28-168	2	Clamp Screw for Stern Bracket.....	JAYHE	.40
*28-173	2	Connecting Rod (All Previous Models K-50 to KA-38 Used 28-12 Connecting Rods).....	JAZBC	2.50
*28-177	1	Cylinder Conversion (Used on K-50 to KA-39).....	JAZBD	17.50
34-19	1	Filler Cap.....	JAUER	1.25
76-112	2	Spark Plug .....	JAXAL	.65

\*Refers to KA-39 parts that differ in quantity or Part No. from those used on KA-38.

**PARTS FOR KAL-38, -39, -10, KSL AND KDL-15 THAT ARE DIFFERENT THAN THOSE USED ON KA-38, -39, -10, KS and KD-15**

Part No.	No. Required per Motor	NAME OF PART	Code Word	List Price per Piece
28-9	1	Shipping Crate.....	JASZG	Net 4.00
28-32	1	Driveshaft .....	JARIE	2.75
28-36	1	Driveshaft Casing .....	JARIC	23.50
28-163	1	Lower Unit Complete Less Propeller .....	JAXQO	80.00

Order All Parts from Nearest Dealer or Service Station

**Always Give Part Number and Motor Number**

**KA-38, -39, -10, KS and KD-15 MAGNETO PARTS**

Part No.	No. Required per Motor	NAME OF PART	Code Word	List Price per Piece
1-20	6	Screw - Condenser Mounting and Ground.....	JACDO	.025
5-114	7	Screw - Coil Mounting.....	JABOS	.025
43-128	1	Feeler Gauge.....	JAYLZ	.10
71-31	2	Screw - Breaker Plate Mounting.....	JABKU	.025
71-36	2	Bushing - Insulation.....	JAGZO	.025
71-45	2	Screw - Spring Mounting.....	JABLY	.025
71-46	2	Lockwasher.....	JAGTO	.025
71-49	6	Plain Washer.....	JABME	.025
71-60	4	Terminal - Cutout Lead.....	JAGVO	.025
71-66	10	Insulation Bushing.....	JABMO	.025
71-78	2	Screw.....	JABNI	.025
71-123	8	Screw - Coil Mounting.....	JAGEP	.025
71-471	8	Nut.....	JAPFA	.025
71-610	2	Plain Washer - Breaker Plate Mounting Screw.....	JAGOP	.025
71-782	2	Tubing - Insulation.....	JAPIJ	.05
71-783	2	Tubing - Insulation.....	JAPID	.05
71-828	2	Screw.....	JAGHR	.025
71-1048	2	Washer - Breaker Post.....	JAPZF	.025
71-1052	2	Clip - Spring.....	JAPZG	.025
71-1054	3	Drive Screw.....	JAQQV	.025
71-1146	2	Contact Point and Screw.....	JAQRB	.20
71-1147	2	Plate - Breaker.....	JAQRC	.10
71-1148	2	Bushing - Insulation.....	JAQRD	.025
*71-1229	2	Terminal - High Tension Lead (Not used on KA-39)	JAREP	.05
71-1240	2	Terminal Breaker.....	JAREQ	.05
71-1245	1	Cam for Flywheel.....	JARES	.35
71-1261	2	Clip - Cutout Lead Mounting.....	JARJN	.025
71-1267	1	Timing Lever.....	JAREU	.50
71-1268	1	Clamp - Ignition Lead.....	JARTU	.05
71-1274	2	Lock Nut - Contact Point and Screw.....	JAREV	.05
71-1369	2	Felt Pad - Condenser Pocket.....	JARTV	.025
71-1420	2	Grommet - High Tension Lead.....	JAWEY	.05

**MAGNETO ASSEMBLIES FOR KA-38, -39, -10, KS and KD-15**

Part No.	No. Required per Motor	NAME OF PART	Code Word	List Price per Piece
72-736	2	Breaker Arm.....	JAPZP	.75
72-781	2	Breaker Plate and Point Assembly.....	JAQRO	.35
72-815	1	Cutout Lead.....	JAQAO	.15
*72-857	1	Ignition Lead - Long (Not used on KA-39).....	JATPK	.45
*72-865	1	Magneto - Complete (Not used on KA-39).....	JAREX	37.00
*72-866	1	Armature Plate Assembly (Not used on KA-39).....	JAREY	24.00
72-867	1	Armature Plate and Clamp Screw.....	JAREZ	3.50
72-868	1	Flywheel.....	JARFA	13.00
72-869	1	Timing Lever Assembly.....	JARFB	1.00
72-871	2	Coil with Heels.....	JARFD	6.00
72-873	2	Condenser.....	JARFE	1.00
72-875	2	Coil - Less Heels.....	JARFF	5.00
72-876	2	Heel - Right.....	JARFG	.45
72-877	2	Heel - Left.....	JARFH	.45
72-881	1	Stop Button.....	JARFI	.20
72-892	1	Cutout Lead.....	JAQXK	.10
*72-992	1	Ignition Lead - Short (Not used on KA-39).....	JAWXR	.45
*72-1093	1	Armature Plate Complete (Not used on KA-38).....	JAZBF	23.00
*72-1094	1	High Tension Lead (Not used on KA-38).....	JAZBG	.45
*72-1095	1	Magneto Complete (Not used on KA-38).....	JAZBH	35.00
*72-1096	1	High Tension Lead - Bottom (Not used on KA-38)....	JAZBE	.45

\*Refers to KA-39 parts that differ in quantity or Part No. from those used on KA-38.

**Order All Parts from Nearest Dealer or Service Station**

Always Give Part Number and Motor Number

**KA-38, 39, 10, KS and KD-15 MAGNETO PARTS**

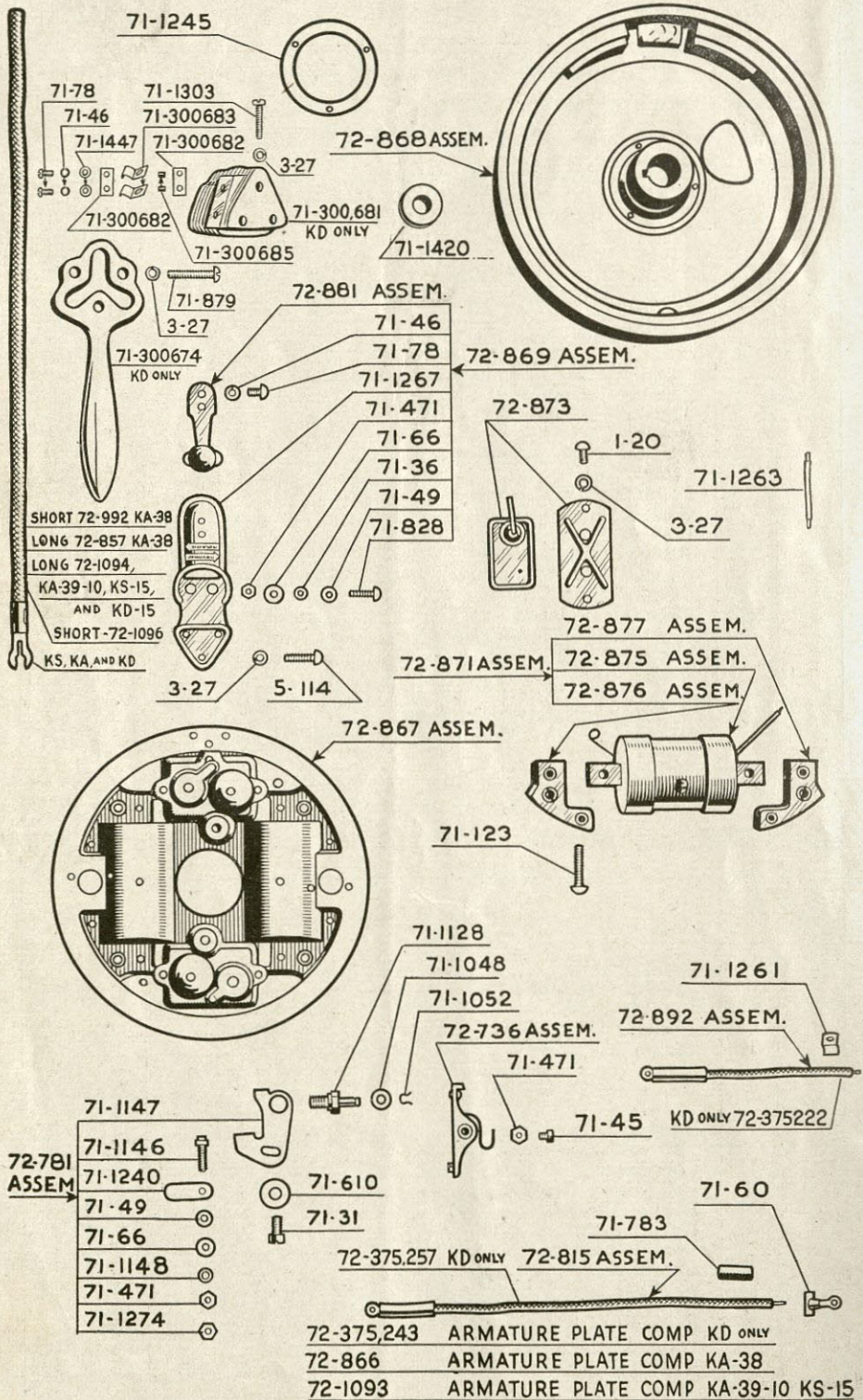

Order All Parts from Nearest Dealer or Service Station

Always Give Part Number and Motor Number

**KA-38, -39, -10, KS and KD-15 CARBURETOR PARTS**

Part No.	No. Required per Motor	NAME OF PART	Code Word	List Price per Piece
1-13	1	Clamp Screw - Throttle Lever.....	JACBY	.025
1-14	2	Lock Nut - Slow Speed Stop Screw.....	JACCA	.025
1-17	1	Set Screw for Choke Lever.....	JACDE	.025
1-64	1	Clamp - Carburetor.....	JARIH	.50
1-93	1	Clamp Screw - Carburetor.....	JAPHR	.10
3-15	1	Cotter Pin - Float Screw.....	JACEB	.025
3-34	1	Wood Screw - Float.....	JACEC	.025
5-114	2	Screw - Slow Speed Stop.....	JABOS	.025
5-175	1	Washer - Plug Drilled Hole.....	JACFI	.025
11-109	3	Screw - Cover to Carburetor.....	JAVZN	.025
11-110	1	Screw - Plug - Drilled Hole.....	JAVZO	.05
13-100	3	Screw - Plug for Drilled Holes.....	JADEJ	.025
13-347	3	Washer - Plug for Drilled Hole Screws.....	JANAJ	.025
25-57	1	Spacer - Clutch - Ball Retainer.....	JARCD	.025
25-184	1	Washer - Low Speed Needle Valve.....	JAXJS	.025
25-188	2	Clutch Ball.....	JAWYF	.025
25-252	1	Clutch Collar.....	JAWYR	.70
25-253	1	Clutch Ball Retainer.....	JAWYC	.20
25-255	1	Lever - Throttle.....	JAWYH	.35
25-262	1	Needle Valve - Low Speed.....	JAWYI	.35
25-263	1	Spring - High Speed Needle Valve.....	JAWYJ	.05
25-270	2	Felt Washer - Needle Valve - Low Speed.....	JAWYK	.025
25-271	1	Key - Barrel Valve Stem.....	JAWYL	.025
25-294	1	Spring - Clutch Ball Retainer.....	JAXJK	.05
25-299	1	Lever - Choke.....	JAXJN	.30
25-303	2	Washer - Thrust.....	JAXJO	.05
25-304	1	Washer - Spring Retainer.....	JAXJP	.025
27-236	1	Washer for Barrel Valve.....	JAWYP	.05
27-256	1	Cover - Carburetor.....	JAXKA	.90
27-303	1	Barrel Valve.....	JAYHO	1.25
27-306	1	Nipple - Slow Speed.....	JAYHQ	.05
27-310	1	Nozzle - Carburetor.....	JAYHR	.10
39-115	1	Plug - Carburetor.....	JAWVB	.025
39-158	1	Spring - Needle Valve - Slow Speed.....	JAWVP	.025
<b>CARBURETOR ASSEMBLIES</b>				
2-24	1	Clamp for Carburetor.....	JAPRC	.75
4-110	1	Float Assembly.....	JACIK	.40
28-120	1	Float Pin.....	JAWYD	.65
28-121	1	Needle Valve - High Speed.....	JAWYE	.50
28-171	1	Carburetor.....	JAYHS	13.00
28-172	1	Carburetor Body and Nozzle.....	JAYHT	5.15

*Length of C Rod - alum -  
" c Bronz-*

*Ring starts 5/16 back from edge + 1/8"*

**Order All Parts from Nearest Dealer or Service Station**

Always Give Part Number, Model and Serial Number of Engine

**PARTS FOR KA-39, -10, KS and KD-15 THAT ARE DIFFERENT THAN  
THOSE USED ON KA-38**

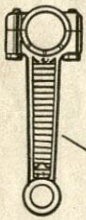

28-173

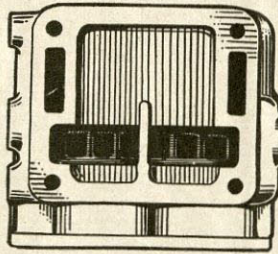

28-116

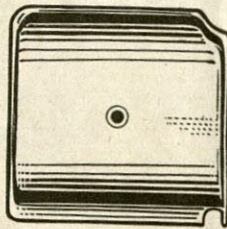

27-327

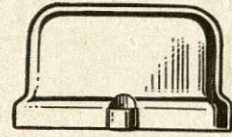

27-326

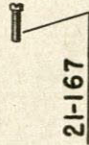

21-167

27-329



72-1094

72-1096

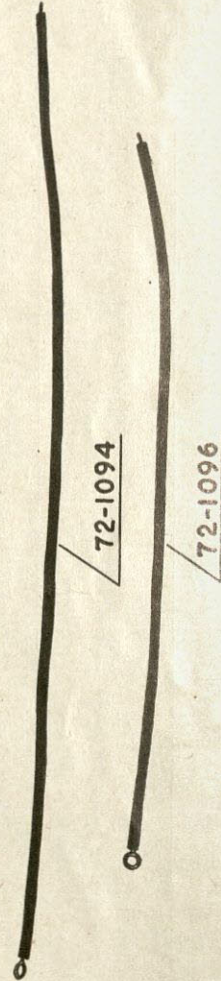

15-195



27-328

Order All Parts from Nearest Dealer or Service Station

Always Give Part Number and Motor Number

**KA-38, -39, -10, KS and KD-15 CARBURETOR PARTS**

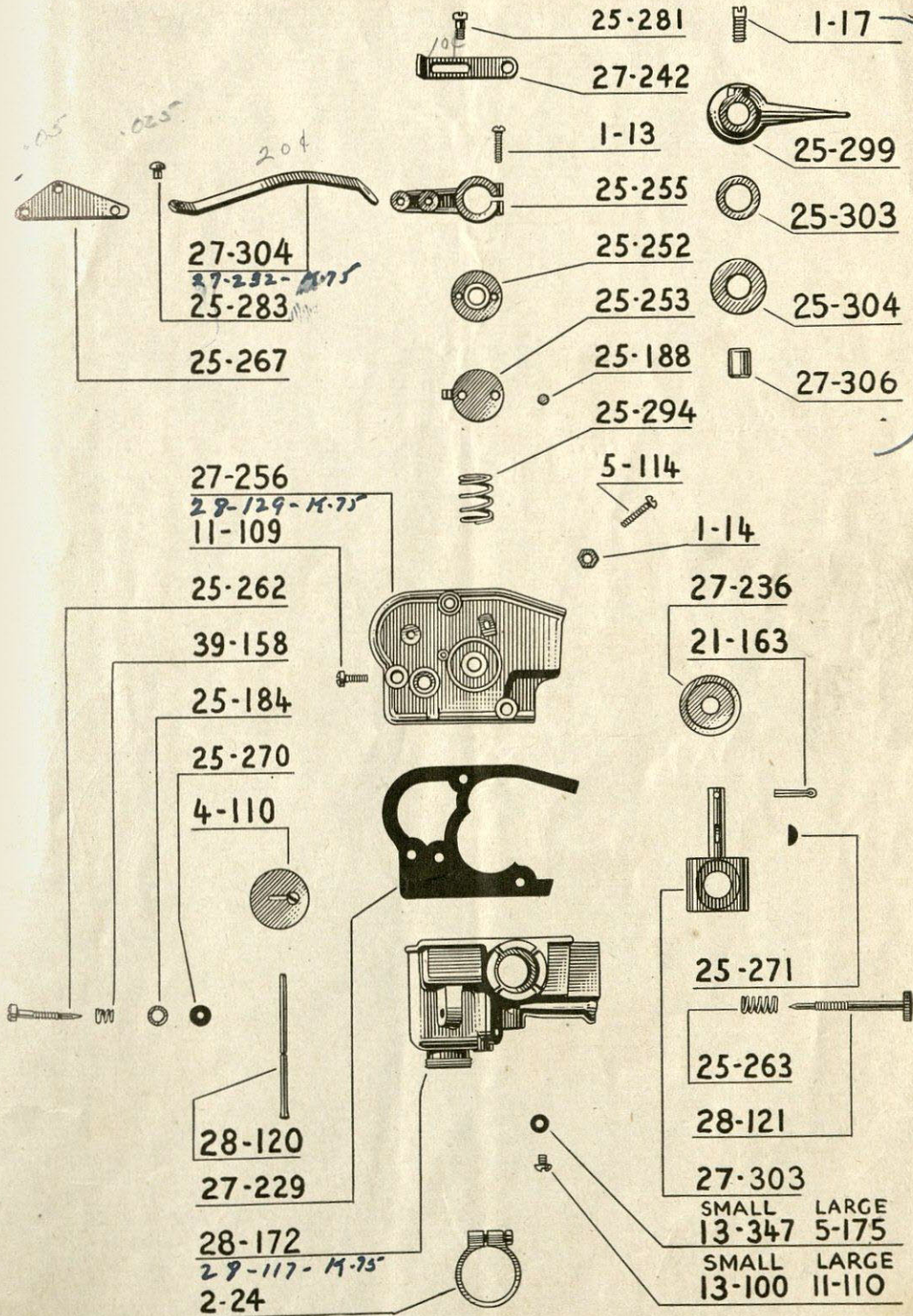

**28-171 ASSEMBLY**

*28-118* " for *H-75* - 12.50

Order All Parts from Nearest Dealer or Service Station

Always Give Number, Model and Serial Number of Engine

**KA-38, 39, 10, KS and KD-15 STARTER PARTS**

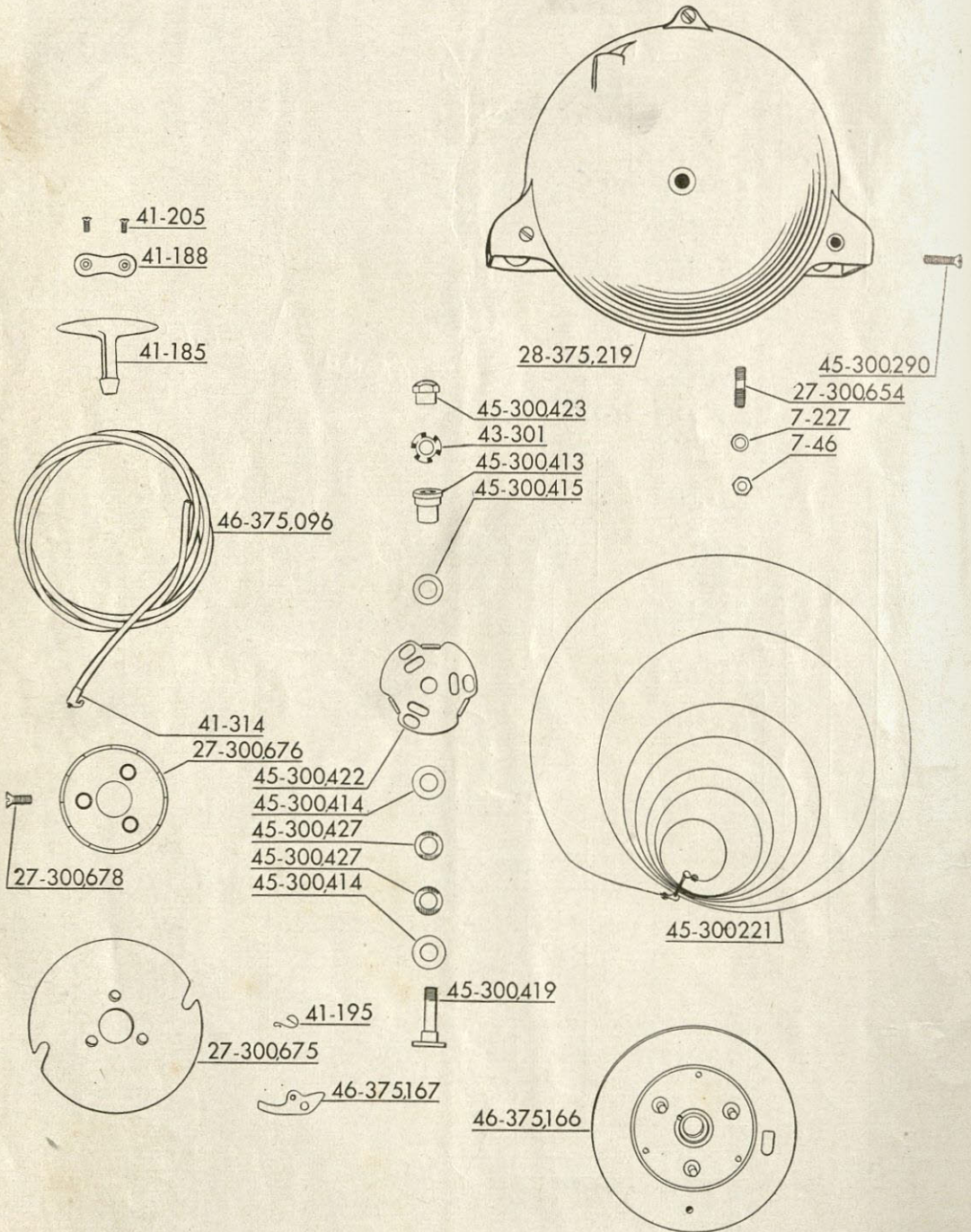

Order All Parts from Nearest Dealer or Service Station



Always Give Number, Model and Serial Number of Engine

**PARTS FOR KS AND KD MOTORS THAT DIFFER FROM  
THOSE USED ON PREVIOUS KA MODELS**

**PARTS FOR KD MOTORS THAT DIFFER FORM THOSE  
USED ON KS AND KA MOTORS**

Part No.	No. Required Per Motor	NAME OF PART	Code Word	List Price per Piece
41-185	1	Starter Handle .....	JAXUL	.55
41-188	1	Clamp Plate - Rope Handle .....	JAXUN	.025
41-195	3	Spring - Pin to Pawl Post .....	JAXUU	.05
41-205	2	Screw - Clamp Plate to Handle .....	JAXVD	.025
41-314	1	Anchor - Starting Cord .....	JAZIV	.15
41-340	1	Socket Wrench .....	JAZCO	.30
43-252	1	Handle - Socket Wrench .....	JAZDY	.15
43-301	1	Washer - Shoulder Screw .....	JAZFO	.05
27-120,325	4	Lockring - Wrist Pin .....	JEBFP	.025
27-300,431	1	Propeller - (KA-37, KA-10, KS-15 and KD-15) .....	JEBFO	7.50
27-300,654	4	Stud - Crankcase Head to Crankcase .....	JEBFQ	.10
27-300,673	1	Nut - Crankcase .....	JEBFR	.25
27-300,675	1	Starter Pulley .....	JEBFU	1.30
27-300,676	1	Ratchet - Starter .....	JEBFS	.30
27-300,678	3	Screw - Ratchet Pulley to Dome .....	JEBFT	.05
45-300,221	1	Main Starter Spring .....	JAZFJ	.70
45-300,290	3	Screw - Starter Housing to Shroud .....	JAZWN	.05
45-300,413	1	Spacer - Hub to Shoulder Screw .....	JEBDI	.25
45-300,414	2	Thrust Washer - Shoulder Screw to Plate .....	JEBDJ	.025
45-300,415	1	Thrust Washer - Spacer to Pawl Plate .....	JAZYG	.025
45-300,419	1	Shoulder Screw - Starter .....	JAZYH	.35
45-300,422	1	Pawl Plate - Starter .....	JEBDK	.05
45-300,423	1	Nut - Shoulder Screw .....	JAZYI	.15
45-300,427	2	Wave Washer - Shoulder Screw .....	JAZYK	.025
<b>MAGNETO PARTS</b>				
3-27	3	Lock Washer - Spacer to Plate Screw .....	JAGIR	.025
71-46	2	Lock Washer - Stop Switch to Spacer Screws .....	JAGTO	.025
71-78	2	Screw - Stop Switch to Spacer .....	JABNI	.025
71-872	1	Rubber Washer - High Tension Leads .....	JAMLF	.025
71-879	3	Screw - Timing Lever Mounting .....	JATLX	.025
71-1303	3	Screw - Spacer Mounting .....	JARXG	.025
71-1447	2	Washer - Contact Screw .....	JAWRH	.025
71-300,674	1	Timing Lever .....	JEBFW	.50
71-300,681	1	Spacer - Timing Lever .....	JEBFX	.65
71-300,682	2	Insulation Block - Contact .....	JEBFY	.025
71-300,683	2	Contact - Cutout .....	JEBFZ	.025
71-300,685	2	Bushing - Insulation .....	JEBGA	.025

**PARTS FOR KS-15 MOTORS THAT DIFFER FROM THOSE  
USED ON PREVIOUS KA MODELS**

Part No.	No. Required Per Motor	NAME OF PART	Code Word	List Price per Piece
27-300,654	4	Stud - Crankcase head to Crankcase .....	JEBFQ	.05
<b>ASSEMBLIES FOR KD MOTORS</b>				
28-375,219	1	Starter Housing - Pin and Shroud Assembly .....	JEBMB	6.50
46-375,096	1	Starter Rope and Anchor .....	JEBBN	1.45
46-375,166	1	Starter Pulley and Ratchet Assembly .....	JEBCN	1.55
46-375,167	3	Pawl and Post Assembly .....	JEBCO	.10

**MAGNETO ASSEMBLIES FOR KD-15 THAT DIFFER FROM THOSE USED ON KS and  
PREVIOUS KA MODELS**

72-375,222	1	Cutout Lead - Short .....	JEBMC	.15
72-375,243	1	Armature Plate Complete .....	JEBMD	23.50
72-375,257	1	Cutout Lead - Long .....	JEBME	.20

**Order All Parts from Nearest Dealer or Service Station**

# JOHNSON MOTORS PARTS DISTRIBUTORS AND SERVICE STATIONS

All Parts should be ordered from your nearest Service Station or Distributor

## ALABAMA

Masters Motor Co.  
422 S. 20th St.  
Birmingham  
A. H. McLeod & Co.  
Dauphin and Water Sts.  
Mobile

## ARIZONA

Motor Supply Co.  
315 N. Central Ave.  
Phoenix

## ARKANSAS

Vaughn Hdw. Co.  
Hot Springs  
Stanley Outboard Motor Co.  
115 Maple St.  
N. Little Rock

## CALIFORNIA

B. H. Hebgren Co.  
1361 S. Flower St.  
Los Angeles  
\*B. H. Hebgren Co.  
326 Market Street  
San Francisco

## CANADA

\*Outboard, Marine & Mfg. Co.,  
of Canada, Ltd.  
Peterborough, Ontario

## CONNECTICUT

Art Kelly's Garage  
495 Lenox Ave.  
Devon  
The Essex Paint & Marine Co.  
Essex

Clapp & Treat, Inc.  
68 State Street  
Hartford

Cook, Newton & Smith, Inc.  
115 Crown St.  
New Haven

Dumont Marine Service  
524-526 Main St.  
New London

## FLORIDA

Bryan-Walker  
Main St.  
Gainesville  
Jacksonville Sptg. Goods Co.  
229 W. Forsythe St.  
Jacksonville

\*Lew Hewes  
841 1/2 Biscayne Blvd.  
Miami

Hopkins-Carter Hdw. Co.  
139 S. Miami Ave.  
Miami

Florida Battery & Equip.  
314 W. Pine St.  
Orlando

Runyan Machine & Boiler  
Works  
Pensacola

J. C. Camp  
Dickson-McLeod  
203 S. Monroe St.  
Tallahassee

Tampa Johnson Sales & Service  
218-20 Tampa Street  
Tampa

## GEORGIA

Stubbs Hdw. & Sptg. Goods Co.  
121 Congress St., West  
Savannah

\*Atlanta Outboard Marine  
311 Spring St., N. W.  
Atlanta

## ILLINOIS

Fred Ludolph  
6350 Stony Island  
Chicago

## ILLINOIS (Continued)

W. L. Masters & Son.  
210-216 W. Chicago Ave.  
Chicago

Maypole Boats and Motors  
5901 W. Madison St.  
Chicago

Hewes Boat Co., Inc.  
Fox Lake

Voss Brothers  
419 S. Adams  
Peoria

Joe Johnson Garage  
1125 4th Avenue  
Rockford

## INDIANA

George N. Meyer  
Lake James  
Angola

Em-Roe Sptg. Goods Co.  
209 Washington St.  
Indianapolis

Korte Bros., Inc.  
219 West Main St.  
Ft. Wayne

J. W. Millikan Sptg. Shop  
449 State Street  
Hammond

Tippecanoe Boat Co.  
Leesburg  
Kindig Bros.  
2222 Mishawaka Ave.  
South Bend

Buffalo Tire Sales  
1311 Wabash Ave.  
Terre Haute

## IOWA

Touristville Boat Livery  
Clear Lake

R. B. Fitch  
Martin Morris & Co.  
229 Fifth Ave., So.  
Clinton

Manawa Boat & Motor Co.  
Box 417  
Council Bluffs

Davidson Co.  
7th and Walnut  
Des Moines

Kautzky Sptg. Gds. Co.  
522 Central Avenue  
Ft. Dodge

## KENTUCKY

Biggerstaff's Fishing Camp  
Burgin

J. C. Bennett Auto Co.  
685 Armory Place  
Louisville

## KANSAS

Radio & Marine Service  
234 S. Topeka  
Wichita

## LOUISIANA

F. C. Winter Merc. Co.  
Pugo & Front Sts.  
Lake Charles

Griffin O. B. Motor Co.  
Monroe

Arthur Duvic's Sons  
122 Chartres St.  
New Orleans

\*S. & L. Service & Storage  
Edwards & Travis St.  
Shreveport

## MAINE

Wells Sptg. Goods Co.  
52 Court St.  
Auburn

Church Electric Co.  
2 Bridge Street  
Augusta

## MAINE (Continued)

Louis Gomez  
65 Fores. Avenue  
Biddeford

Louis Gomez  
243 Main Street  
Saco

Albert G. Frost  
24 Forest Ave.  
Portland

## MARYLAND

G. Elmer Stagner  
1520 N. Gay St.  
Baltimore

## MASSACHUSETTS

\*Crandall-Hicks Company  
959 Commonwealth Ave.  
Boston

Outboard Motor Mart, Inc.  
305 Atlantic Ave.  
Boston

Rapp-Huckins Co., Inc.  
138 Beverly St.  
Boston

Allen Harbor Marine Service  
Harwich Port

Crandall Company  
563 Main St.  
Springfield

## MICHIGAN

W. Johnson Service  
114 N. Winter Street  
Adrian

Bay City Hdw. Co.  
1009 Saginaw St.  
Bay City

\*Henry H. Smith Co.  
333 Jefferson Ave., E.  
Detroit

Outboard Service  
3205 Detroit St.  
Flint

C. G. Baisch  
136 Michigan St., N. W.  
Grand Rapids

Erickson Boat Shop  
Harbor Springs

Clark's Camp  
Houghton Lake

Junction Auto Parts  
3315 E. Michigan Ave.  
Jackson

Shand's  
Plainwell

Parker Boat Livery  
Klinger Lake  
Sturgis

Murray Boat Shop  
447 E. Front St.  
Traverse City

## MINNESOTA

Alexandria Hdw. & Lbr. Co.  
Alexandria

A. C. White Sptg. Shop  
Brainerd

Alva Baker & Company  
Deer River

Duluth Hardware Co.  
19-21 2nd Ave., N.  
Duluth

George & Henry  
331 East Superior Street  
Duluth

United Elec. Service Co.  
301 E. Superior St.  
Duluth

Forest Chevrolet Company  
303 E. Sheridan Street  
Ely

Paul H. Kinports  
923 Third St.  
International Falls

Note: Those Starred (\*) are Parts Distributors who carry a complete stock of parts.

# JOHNSON MOTORS PARTS DISTRIBUTORS AND SERVICE STATIONS

All Parts should be ordered from your nearest Service Station or Distributor

## MINNESOTA (Continued)

Larson Boat Works  
First St., N. E.  
Little Falls  
Mahowald Cycle Co.  
Mankato  
Nelson Sales & Service  
1508 Hennepin Ave.  
Minneapolis  
Nissawa Oil Co.  
Nissawa  
Auto Marine Shop  
Ramier  
\*Motor Power Equipment Co.  
Ford Road & River Blvd.  
St. Paul  
Parks Machine Co.  
199 W. 6th St.  
St. Paul  
McClellan Auto Elec.  
Virginia  
Walker Hdwe.  
Walker

## MISSOURI

\*Star Boat & Motor Co.  
7414 E. 15th St.  
Kansas City  
Ralph G. Schmitt & Co.  
1211 S. Vandeventer Blvd.  
St. Louis  
Herrick Motor Company  
427 College Street  
Springfield  
S. Huston Elsner  
Sweet Springs

## NEBRASKA

Mills Cycle & O. B. Shop  
117 W. Fifth Street  
North Platte  
City Gun & Lock Co.  
317 South 14th St.  
Omaha

## NEW JERSEY

Dale Yacht Basin  
Bayhead  
Hockenjos Boat Co.  
Great Cove  
Lake Hopatcong  
Harry Collins  
346 Main St.  
Mays Landing  
Carl W. Bush Company  
518 Broad St.  
Newark  
Fred Jacoby  
828 Anderson St.  
North Berger

## NEW YORK

F. R. Smith & Son  
Bolton Landing  
Buffalo Marine Mart  
1261 Niagara St.  
Buffalo  
Rich Marine Sales  
Foot of Amhurst St.  
Buffalo  
Swan Garage, Inc.  
48 Swan Street  
Buffalo  
Charles C. Cool  
61 Geneva St.  
Geneva  
\*Automotive Electric Service  
Corp.  
40 W. 62nd St.  
New York City  
Erl Hauptner  
435 City Island Ave.  
City Island  
Dunkirk Motor Boat Service  
11 Lake Shore Drive, E.  
Dunkirk  
Bronx Johnson Motor Co.  
3395 East Fremont Ave.  
N. Y. City  
Armstrong & Galbraith  
623-5 6th Ave.  
N. Y. City  
Ward's Sptg. Store  
321 Isabelle St.  
Ogdensburg  
Whichone, Inc.  
1308 Broadway  
Albany  
McFarland Hardware  
Niagara Falls

## NEW YORK (Continued)

Valentine Brothers  
134-18 Northern Blvd.  
Flushing  
Rochester Marine Co., Inc.  
48 Scio St.  
Rochester  
F. M. Baker  
119 River St.  
Saranac Lake  
Syracuse Boat Co.  
935 S. Salina St.  
Syracuse  
Harry H. Henry  
1598 Broadway  
Watervliet

## NORTH CAROLINA

Roy Parker  
106 Coxe Ave.  
Asheville  
Pickard's Sptg. Goods  
209 Market Street  
Wilmington

## NORTH DAKOTA

Emery-Johnson Carnine Co.  
7-9 S. Broadway  
Fargo

## OHIO

Anchor Canoe Livery  
(M. F. Cooper, Mgr.)  
1007 Bowery St.  
Akron  
C. E. Baker  
Buckeye Lake  
Cincinnati Yacht & Supply Co.  
2001 Eastern Ave.  
Cincinnati  
Powell & Clement  
420 Main St.  
Cincinnati  
Barnes Boat Mart  
3107 Detroit Ave.  
Cleveland  
\*Zucker Marine Supply Co.  
5300 St. Clair Ave., N. E.  
Cleveland  
W. C. Kennedy & Son  
20 E. Rich St.  
Columbus  
Worthy R. Brown & Son  
Lakeside  
Hall Bros. Garage & Mach.  
114-116 Greene Street  
Marietta  
H. Drue Alexander  
Russell's Point  
Worthy Brown & Sons, Inc.  
Cedar Point Pier  
Sandusky  
The Union Supply Co.  
27-31 Superior St.  
Toledo

## OREGON

\*The Beebe Company  
504 S. W. First Ave.  
Portland

## PENNSYLVANIA

Mattis Boat & Motor  
19 W. Fourth St.  
Erie  
\*Johnson & Towers, Inc.  
113-115 Market St.  
Philadelphia  
Robt. S. Miller  
Evergreen St.  
Harrisburg  
Jack's B & R Service  
2220 Germantown Ave.  
Philadelphia  
Morgan Boat & Equip. Co.  
905 May Building  
Pittsburgh

## RHODE ISLAND

Gustave L. Heureux  
2210 Broad St.  
Edgewood Station  
Providence.

## SOUTH CAROLINA

Johnson Outboard Motor Service  
603 Main St.  
Columbia

## SOUTH DAKOTA

Grovers Master Service Station  
Aberdeen

## TENNESSEE

York Arms Company  
162 S. Main Street  
Memphis  
Volunteer Motor Co.  
119 N. 3rd Avenue  
Nashville

## TEXAS

Boats & Motors, Inc.  
412 Congress Ave.  
Austin  
E. A. Blanchette  
Beaumont  
Cullum & Boren  
1509 Elm Street  
Dallas  
Lechenger Marine Store  
1102 Leeland at Fannin  
Houston  
Potchernicks  
211 St. Mary's St.  
San Antonio

## VERMONT

Champlain Marine Co., Inc.  
Burlington  
Chas. R. McMaster  
105 State St.  
Rutland, Vt.

## VIRGINIA

Motor Boat Sales, Inc.  
3 West Grace St.  
Richmond  
Tignor's Inc.  
735 E. Main St.  
Richmond

## WASHINGTON

\*Pacific Marine Supply Co.  
1223 Western Ave.  
Seattle

## WEST VIRGINIA

Groves-Thornton Co.  
810 Fourth Street  
Huntington  
Everett Greiner  
1705 Staunton Street  
Parkersburg

## WISCONSIN

Bricknell's Valley Marine Sales  
40 Lake Drive  
Oshkosh  
Sherrill Outboard Shop  
Chetek  
J. A. Dewyer Boat Works  
Eagle River  
Gordon Bent Co.  
125 Main St.  
Green Bay  
Marx Appliance  
La Crosse  
Ruggles Motor Service  
1848 Kenilworth Place  
Milwaukee  
Bassetts Super Service Station  
Minocqua  
A. L. Haglun  
% Larson Chev. Co.  
Superior  
A. L. Koch Co.  
302 W. College Ave.  
Appleton

Note: Those Starred (\*) are Parts Distributors who carry a complete stock of parts.

