

SHROUD GROUP

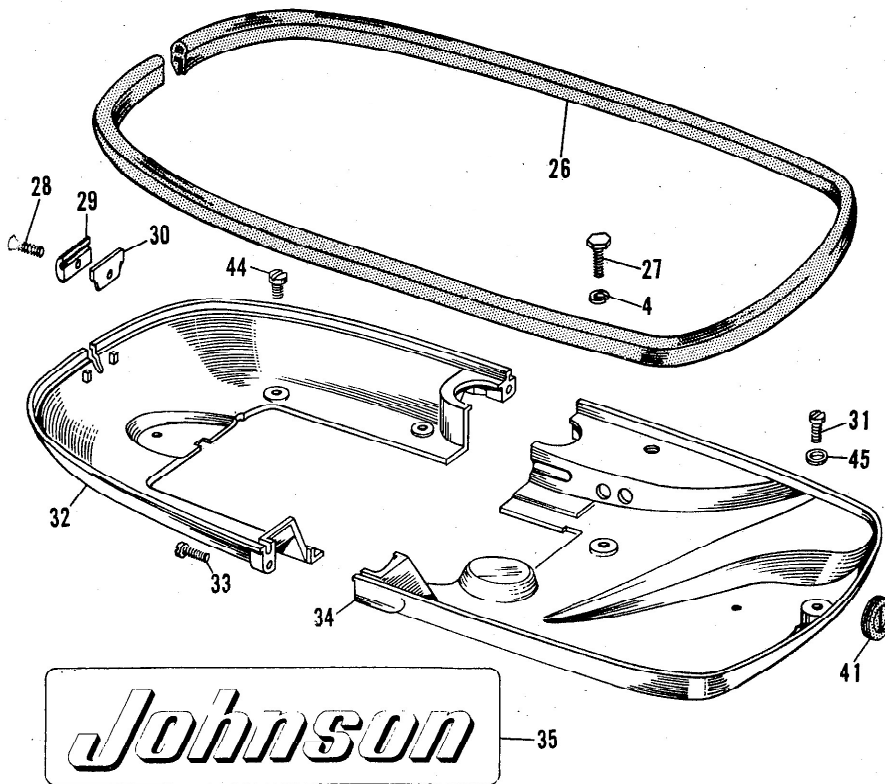
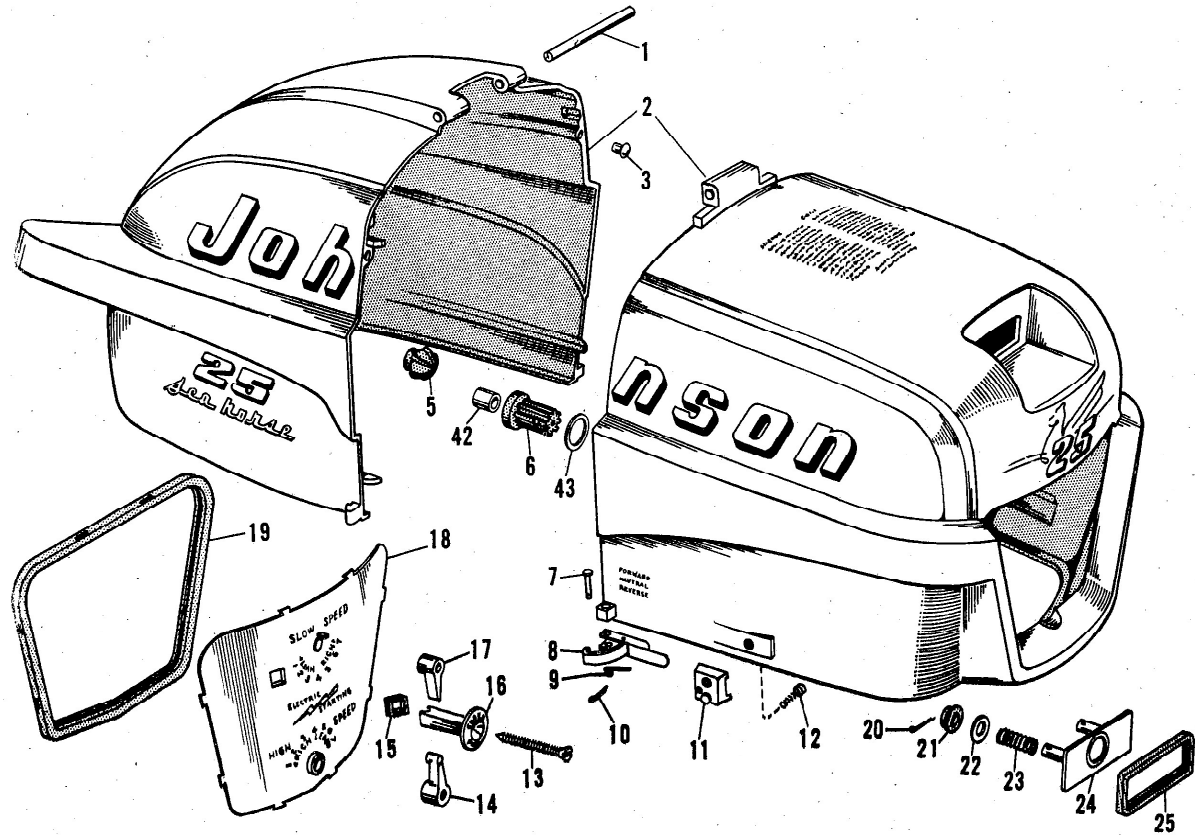

INSTRUCTIONS

STARTING

OILING

Always use the correct oil for the engine. The oil should be changed at the intervals specified in the manual. The oil should be changed before the engine is started. The oil should be changed before the engine is started. The oil should be changed before the engine is started.

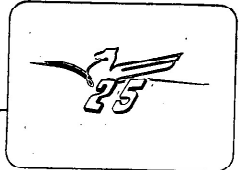

25
Sea Horse

ELECTRIC
STARTING

FORWARD
NEUTRAL
REVERSE