

PARTS CATALOG

FOR

Models QD-12 and 13

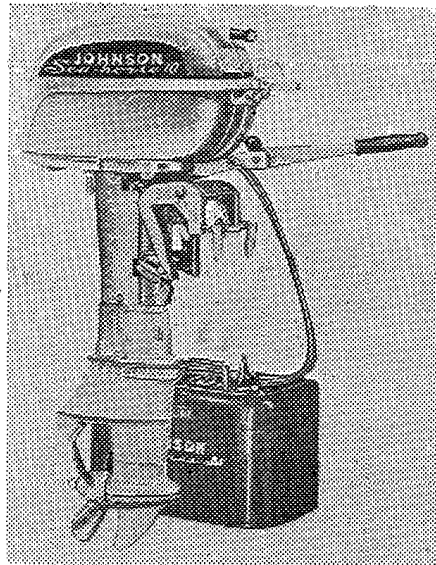

SEA-HORSE 10

JOHNSON MOTORS

Waukegan, Illinois, U. S. A.

All Prices Subject to Change Without Notice

Warranty

We warrant each new outboard motor of our manufacturers to be free from defects in material and workmanship under normal use and service, our obligation under this warranty being limited to making good at the factory any part or parts thereof which shall, within three (3) months after delivery of such motor to original purchasers, be returned to us with transportation charges prepaid, and which our examination shall disclose to our satisfaction to have been thus defective; this warranty being expressly in lieu of all other warranties and representations expressed or implied and of all other liabilities in connection with the sale or use of any motors.

This warranty shall not apply to any motor which shall have been repaired or altered outside the factory in any way so as to affect its stability, nor which has been subject to misuse, negligence or accident. Warranty is void if motor is used for racing purpose.

We make no warranty in respect to trade accessories not of our manufacture; inasmuch as they are usually warranted separately by their respective manufacturers.

Because of the usual strains and accidents to which such products may be subjected, we make no warranty of either material or workmanship in racing outboard motors or any of our products when used for racing.

Claims must be entered on motors or motor parts returned to the factory for inspection, repair or replacement. Request form No. SE-16 from local Johnson Dealer or Service Station. This form should be filled in, signed by the motor owner and dealer or service station representatives and mailed to the factory with returned material, **TRANSPORTATION CHARGES PREPAID.**

Be Sure to Specify Model and Serial Number of Motor When Ordering Parts

MAGNETO

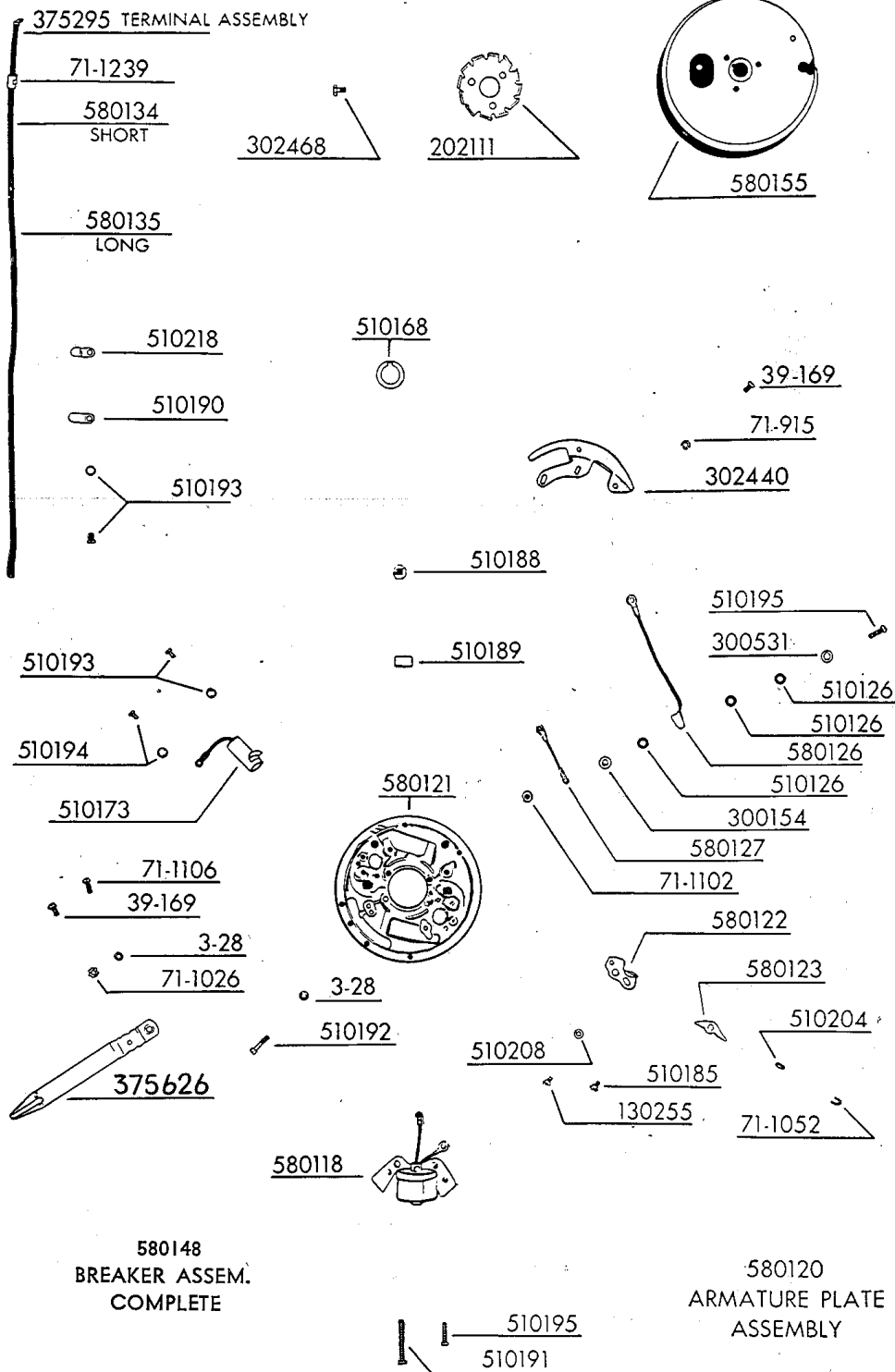

Order All Parts from Nearest Service Station or Dealer

Be Sure to Specify Model and Serial Number of Motor When Ordering Parts

POWER HEAD

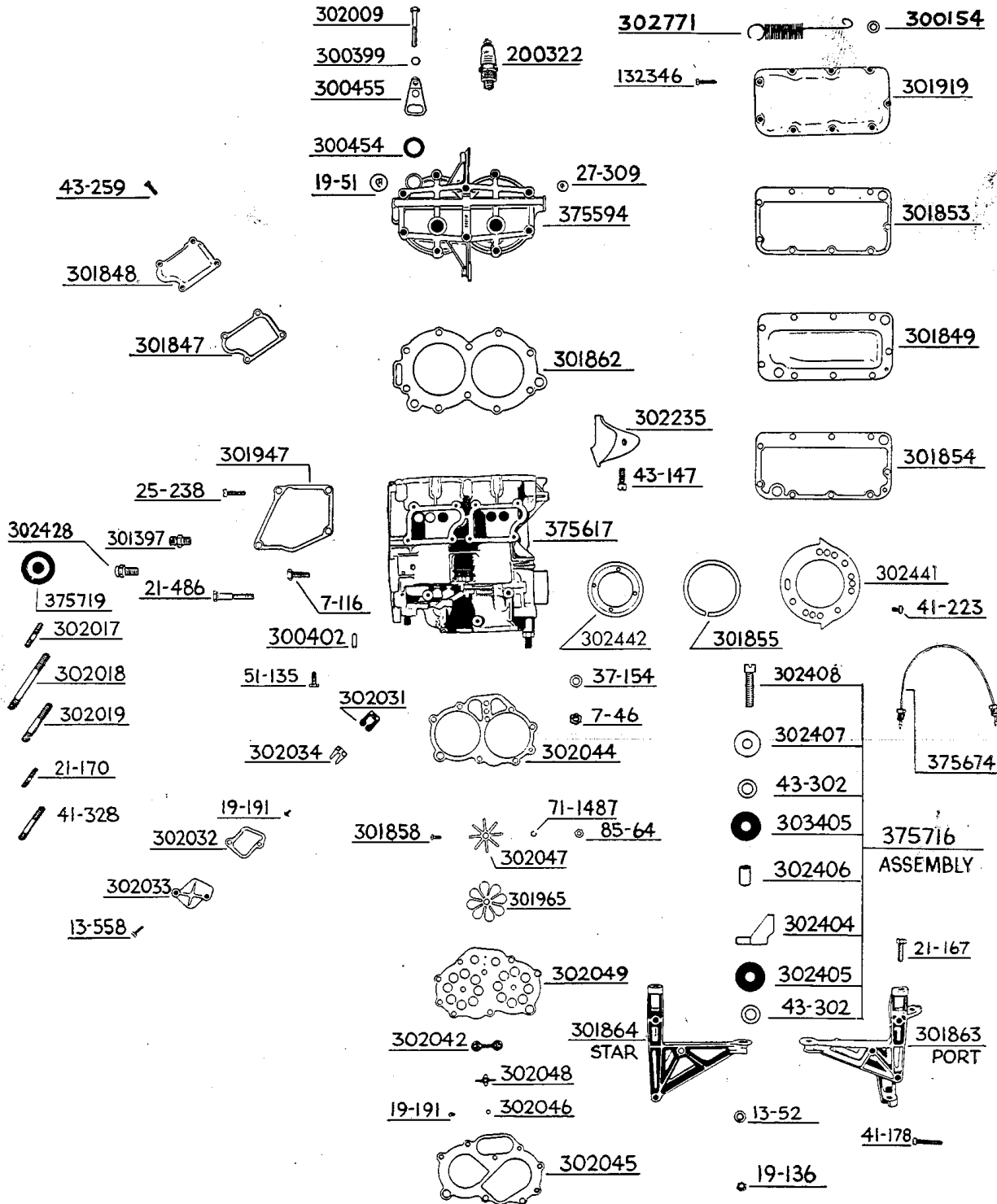



Order All Parts from Nearest Service Station or Dealer

POWER HEAD

*Main
Springs
1 set
Springs*

301988 

301857 

301861 

301860 

301967 

302036 

302035 

302499 

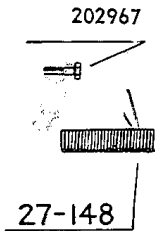
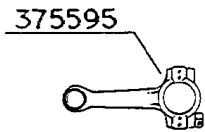
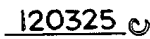
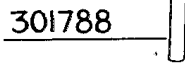
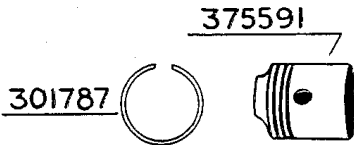

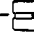

19-89

302499 

302035 

302036 

301967 

301860 

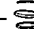
301861 

301857 

301859 

Order All Parts from Nearest Service Station or Dealer

Be Sure to Specify Model and Serial Number of Motor When Ordering Parts

CARBURETOR

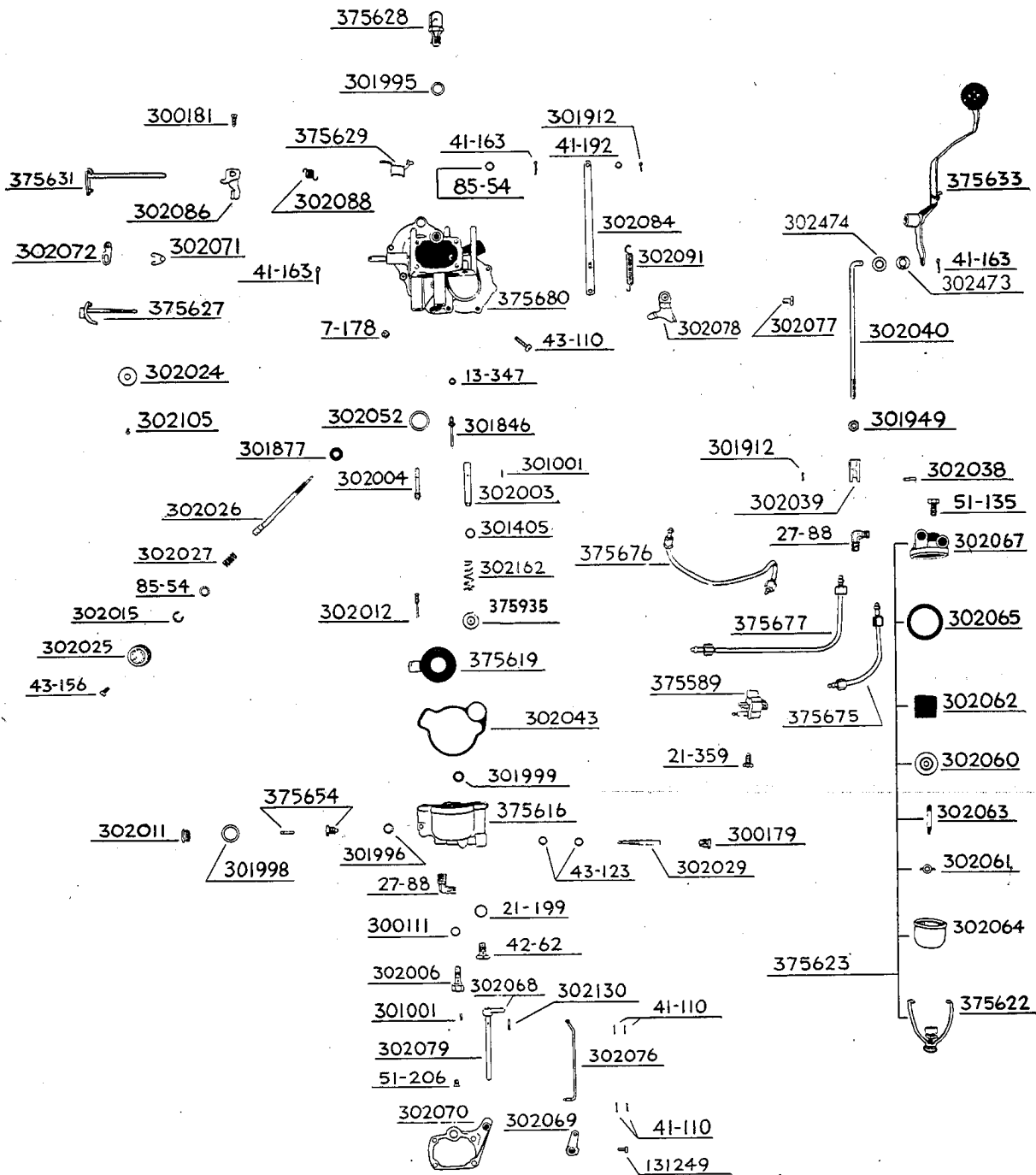

375680 · CARBURETOR BODY-VALVE AND VENTURI ASSEMBLY

375670 · CARBURETOR ASSEMBLY COMPLETE

302025

43-156

375683 · FLOAT BOWL ASSEMBLY

375623 · GASOLINE FILTER ASSEMBLY

Order All Parts from Nearest Service Station or Dealer

SHROUDS AND TRANSFERS

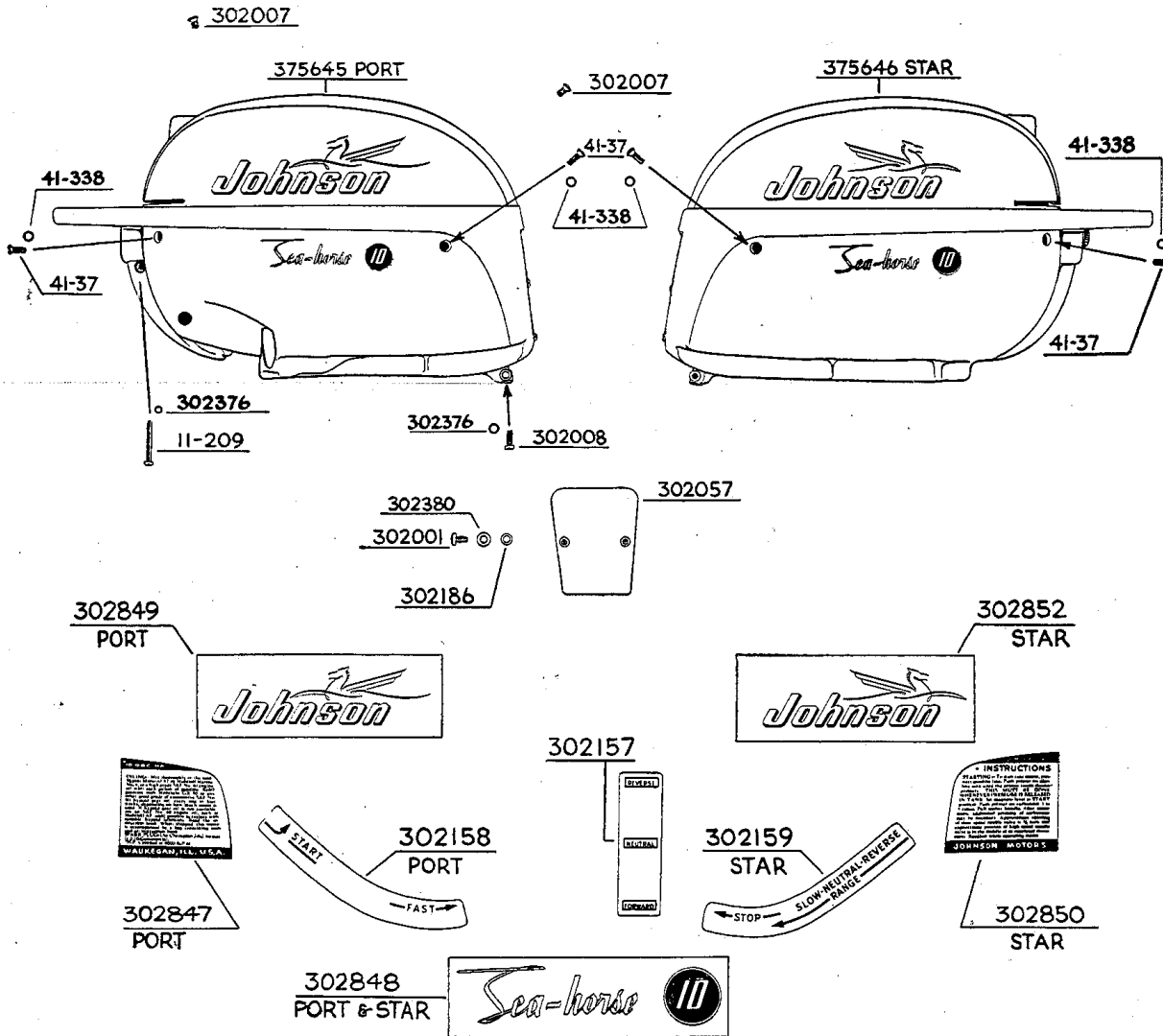

Order All Parts from Nearest Service Station or Dealer

LOWER UNIT

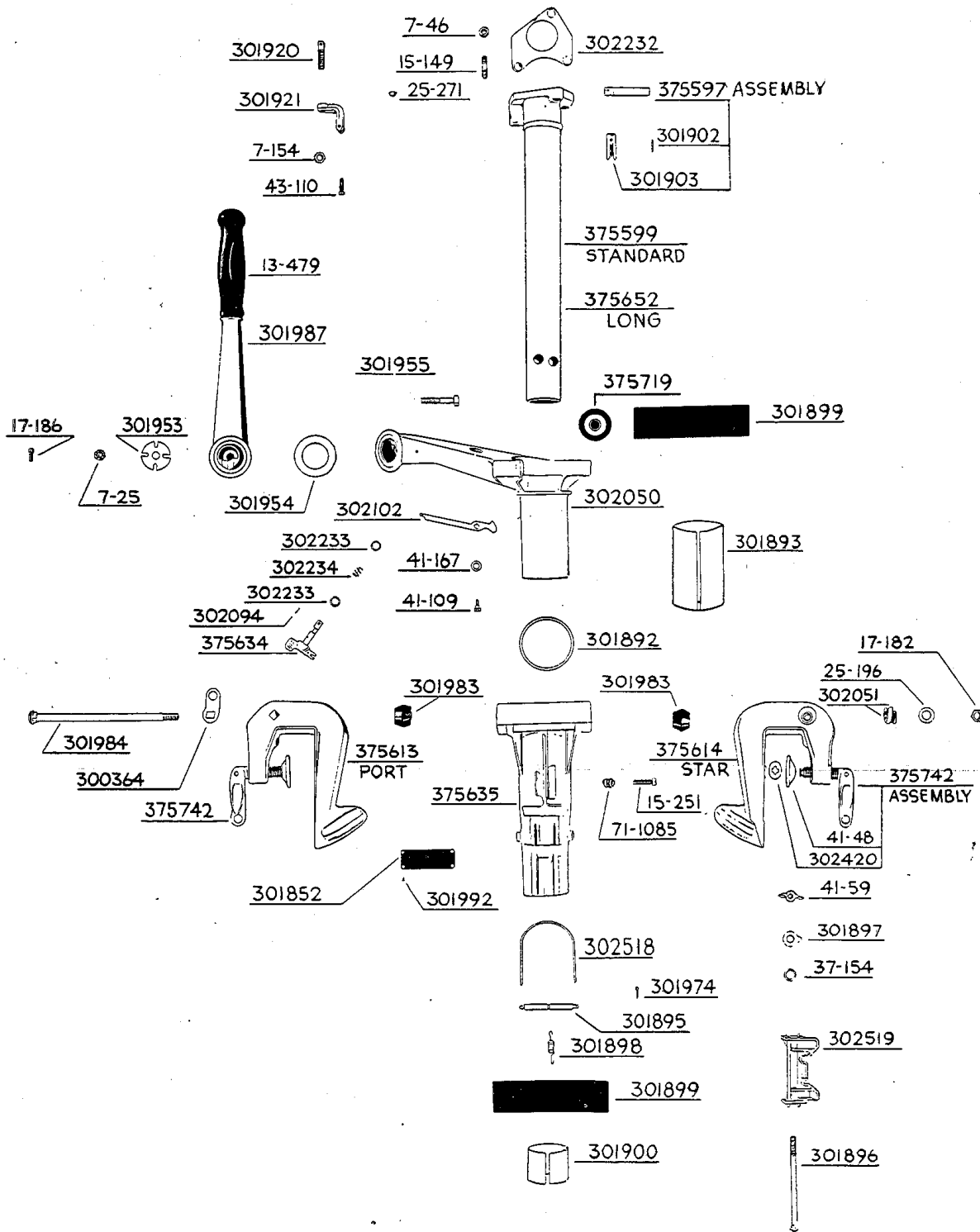

Order All Parts from Nearest Service Station or Dealer

LOWER UNIT

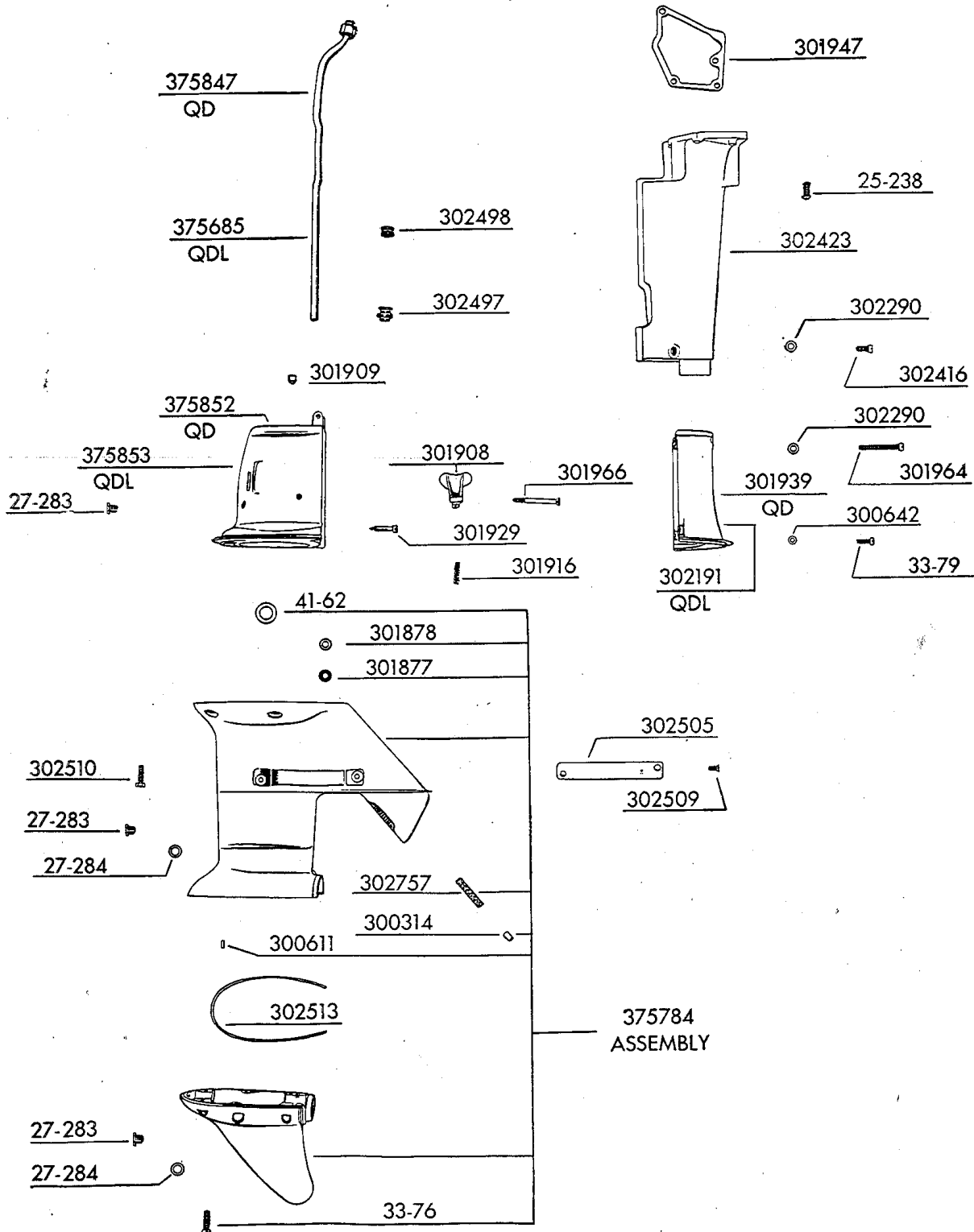

Order All Parts from Nearest Service Station or Dealer

LOWER UNIT

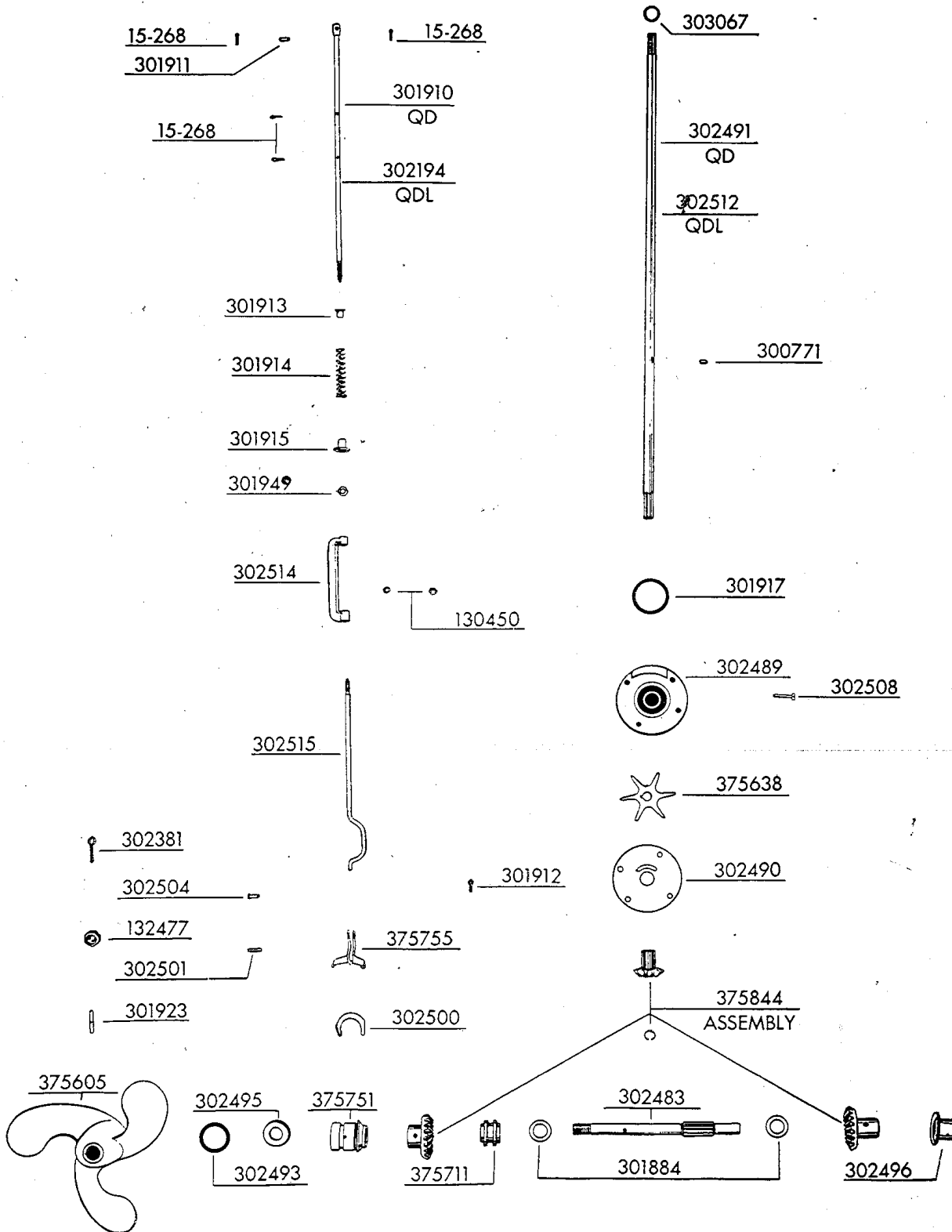

Order All Parts from Nearest Service Station or Dealer

STARTER ASSEMBLY

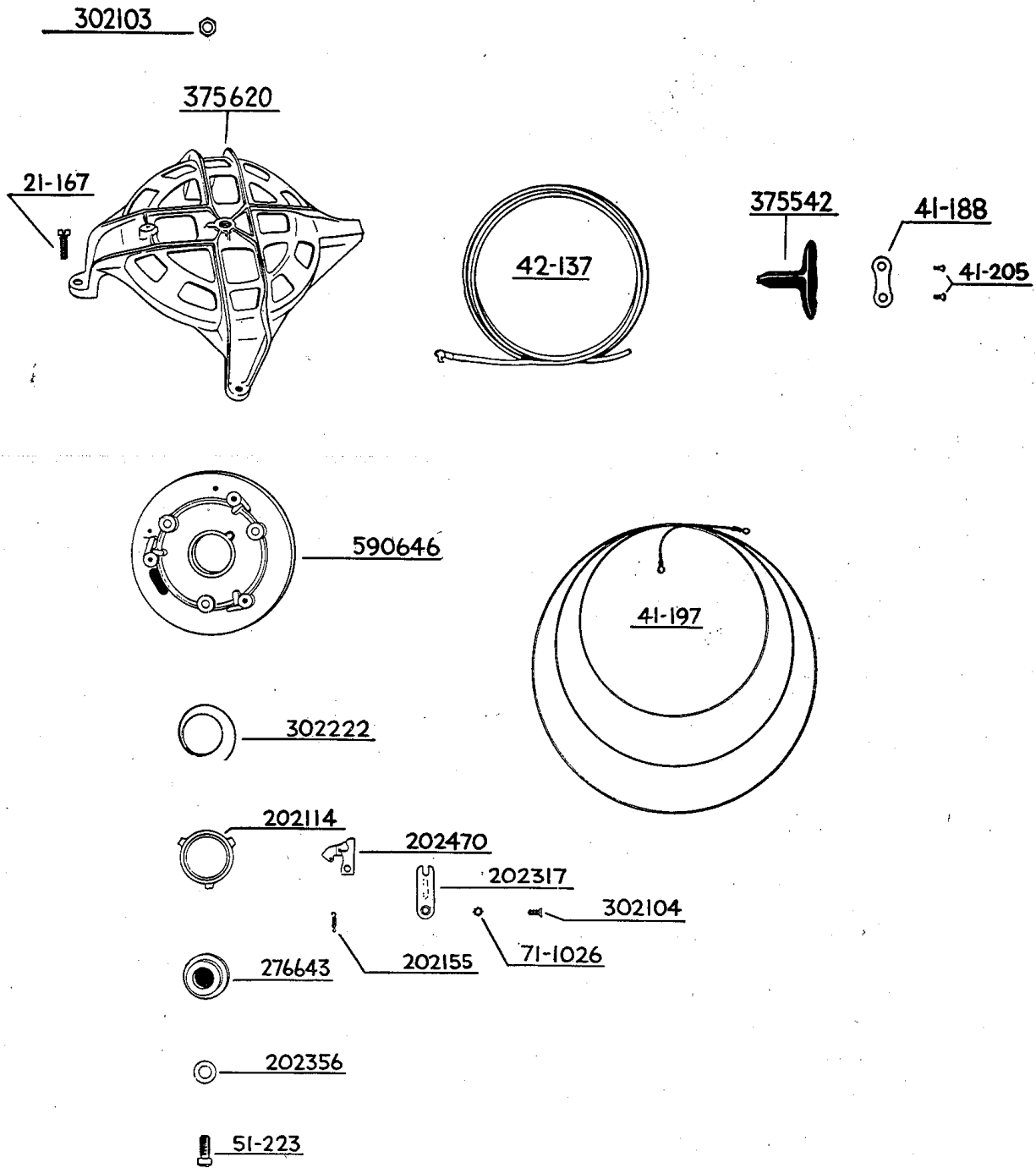

STARTER ASSEMBLY COMPLETE - 375681

Order All Parts from Nearest Service Station or Dealer

MILE MASTER FUEL TANK

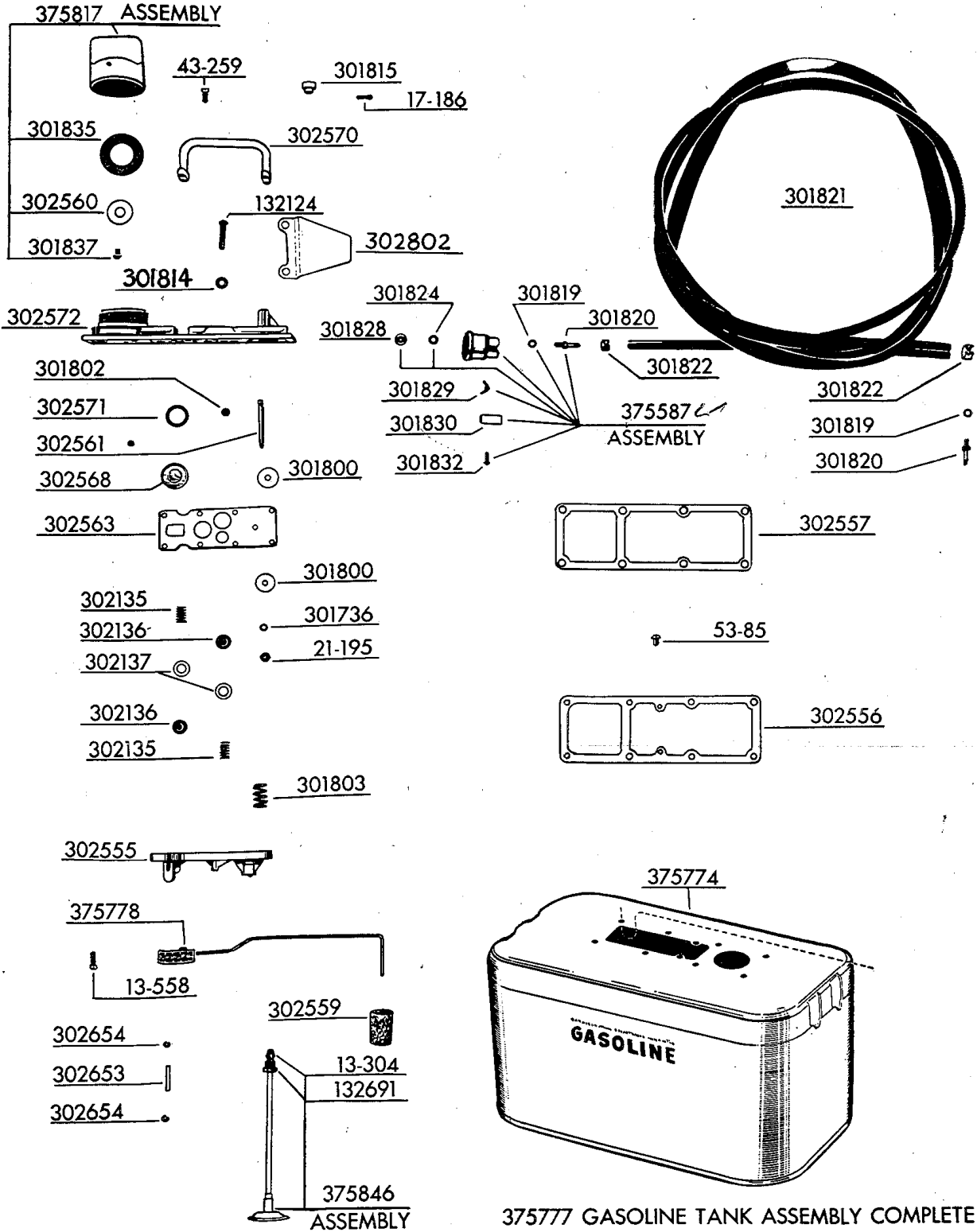

Order All Parts from Nearest Service Station or Dealer

PART No. 3-28 TO PART No. 42-62 INCL.

Part No.	No. Required per Motor	NAME OF PART	List Price per Piece
3-28	3	Lockwasher - Retaining Ring Mounting, Timing Lever.....	.025
7-25	1	Nut - Steering Handle to Bracket.....	.10
7-46	7	Nut - Flange to Power Head and Cylinder to Crankcase Assembly025
7-116	1	Screw - Flange to Cylinder - Short.....	.15
7-154	1	Nut - Clamping Lever Extension.....	.05
7-178	1	Core Plug - Carburetor Body.....	.15
11-209	1	Screw - Shroud - Port to Star - Front.....	.15
13-52	4	Lockwasher - Rubber Mounting.....	.025
13-304	1	Gland - Gas Line.....	.025
13-347	1	Gasket - Jet - Carburetor.....	.025
13-479	1	Rubber Grip55
13-558	10	Screw - Lower to Upper Housing - Leaf Valve Cover to Crankcase05
15-149	1	Stud - Flange to Power Head.....	.10
15-251	1	Screw - Swivel Bracket.....	.025
15-268	4	Cotter Pin - Shift Rod and Shift Rod Pin.....	.025
17-182	1	Nut - Tilting Shaft Bolt.....	.15
17-186	2	Cotter Pin - Push Button - Steering Handle.....	.025
19-51	1	Core Plug - Cylinder Head.....	.025
19-89	1	Key - Woodruff #6 - Crankshaft.....	.025
19-136	4	Nut - Shroud Mounting Screw.....	.05
19-191	4	Screw - Leaf Valve Cover to Crankcase - Check Valve to Leaf Plate.....	.05
21-167	3	Screw - Starter Housing to Mounting Plate.....	.025
21-170	2	Stud - Crankcase to Cylinder.....	.10
21-195	1	Nut - Push Rod.....	.10
21-199	1	Washer - Check Valve - Carburetor.....	.025
21-359	1	Screw - Fuel Connector to Bracket.....	.025
21-486	1	Screw - Flange to Cylinder - Long.....	.05
25-196	1	Washer - Tilting Shaft.....	.05
25-238	5	Screw - Exhaust Tube.....	.05
25-271	1	Key - Clamping Lever to Shaft.....	.05
27-88	3	Elbow - Gasoline Line - Filter Body.....	.20
27-148	58	Needle Bearing - Connecting Rod.....	.025
27-283	3	Plug - Oil - Fill and Drain - Flushing Hole.....	.30
27-284	2	Washer - Oil Plug - Fill and Drain.....	.025
27-309	1	Core Plug - Cylinder Head.....	.05
33-76	6	Screw - Upper to Lower Gear Housing.....	.10
33-79	2	Screw - Cover to Upper Pump Housing.....	.05
37-154	7	Washer - Cylinder and Crankcase and Crankcase Studs - Thrust Socket Bolt.....	.025
39-169	4	Screw - Timing Lever and Throttle Cam.....	.025
41-37	4	Screw - Shroud to Bracket.....	.05
41-48	2	Swivel Plate - Clamp Screw.....	.10
41-59	1	Wing Nut - Thrust Socket Bolt.....	.45
41-62	1	Seal - Driveshaft.....	.60
41-109	1	Screw - Lever to Steering Bracket.....	.10
41-110	4	Pin - High Speed Link.....	.025
41-163	4	Cotter Pin - Shift Lever - Cross Shaft - Shift Lever Link to Shift Lever.....	.025
41-167	1	Bow Washer - Lever to Screw.....	.025
41-178	6	Screw - Bracket to Power Head.....	.025
41-188	1	Clamp Plate - Rope Handle.....	.05
41-192	1	Washer - Cross Shaft Pin.....	.025
41-197	1	Starter Spring	1.10
41-205	2	Screw - Clamp Plate to Handle.....	.025
41-223	4	Screw - Armature Plate Support.....	.05
41-328	1	Stud - Crankcase to Cylinder.....	.10
41-338	4	Lockwasher - Shroud to Bracket.....	.025
42-62	1	Check Valve	1.10

Order All Parts from Nearest Service Station or Dealer

PART No. 42-137 TO PART No. 301800 INCL.

Part No.	No. Required per Motor	NAME OF PART	List Price per Piece
42-137	1	Starter Cord and Anchor.....	1.95
43-110	8	Screw - Carburetor Body to Crankcase - Clamping Lever...	.025
43-123	2	Packing - High Speed Needle Valve.....	.025
43-147	1	Screw - Plug - Bypass - Lower.....	.025
43-156	2	Screw - Adjusting Knob.....	.025
43-259	12	Screw - Bypass Cover.....	.025
43-302	8	Washer (small) Shroud Mounting.....	.025
51-135	6	Screw - Crankcase to Cylinder and Filter to Bracket.....	.05
51-206	4	Screw - Control Shaft Bracket.....	.025
51-223	1	Screw - Spindle to Starter Housing.....	.05
53-85	2	Screw - Support Plate to Tank.....	.025
71-915	3	Lockwasher - Cam to Armature Plate.....	.025
71-1026	4	Shakeproof Lockwasher - Timing Lever - Retainer Screw...	.025
71-1052	2	Spring Clip - Breaker Assembly.....	.025
71-1085	1	Spring - Swivel Bracket (Order 303562).....	
71-1102*	1	Nut - Stop Switch.....	.025
71-1106	1	Screw - Timing Lever.....	.10
71-1239	1	Marker - High Tension Lead - Short.....	.05
71-1487	2	Lockwasher - Leaf to Leaf Plate Screw.....	.05
85-54	2	Washer - Cross Shaft and Slow Speed Needle Valve.....	.025
85-64	2	Nut - Leaf to Leaf Plate Screw.....	.025
120325	4	Lockring - Piston Pin.....	.025
130255	2	Screw - Breaker Mounting.....	.025
130450	2	Nut - Link to Lower Shift Rod.....	.025
131249	1	Screw - Slow Speed Stop.....	.10
132124	8	Screw - Support Plate to Housing.....	.20
132346	9	Screw - Exhaust Cover to Cylinder.....	.025
132477	1	Nut - Propeller.....	.60
132691	1	Nut - Gas Line.....	.10
200322	2	Spark Plug.....	.80
202111	1	Ratchet - Starter.....	.35
202114	1	Equalizer Cup.....	.20
202155	3	Spring - Equalizer Cup.....	.10
202317	3	Retainer - Starter Pawl.....	.20
202356	1	Washer - Starter Spindle.....	.10
202470	3	Starter Pawl.....	.20
202967	4	Screw - Connecting Rod.....	.30
276643	1	Spring and Pin Assembly.....	.55
300111	1	Gasket - Float Valve Seat.....	.10
300154*	2	Washer - High Tension Lead Spring - (*Stop Switch).....	.025
300179	1	Packing Nut - Carburetor.....	.10
300181	1	Screw - Barrel Valve Cover.....	.10
300314	1	Plug - Screen - Water Intake.....	.05
300364	1	Link - Safety Chain.....	.05
300399	10	Washer - Cylinder Head Screw.....	.025
300402	2	Taper Pin - Cylinder and Crankcase.....	.05
300454	1	Grommet - High Tension Lead Anchor.....	.05
300455	1	Anchor - High Tension Lead.....	.05
300531*	1	Cup Washer - Stop Switch.....	.025
300611	2	Dowel - Front and Rear Bearing.....	.025
300642	2	Lockwasher - Cover to Upper Pump Housing Screw.....	.025
300771	1	Pin - Driveshaft to Impeller.....	.025
301001	2	Groove Pin - Control Shaft Arm and Plunger.....	.15
301397	1	Straight Connector - Cylinder.....	.20
301405	1	Washer - Plunger.....	.05
301736	1	Lockwasher - Push Rod.....	.025
301787	6	Piston Ring.....	.35 ✓
301788	2	Wrist Pin.....	.35
301800	2	Support - Diaphragm.....	.05

*Note —Parts used only on Model QD-12 Motors below Serial Number 876796.

Order All Parts from Nearest Service Station or Dealer

Be Sure to Specify Model and Serial Number of Motor When Ordering Parts

PART No. 301802 TO PART No. 301947 INCL.

Part No.	No. Required per Motor	NAME OF PART	List Price per Piece
301802	1	Disc Valve05
301803	1	Spring - Fuel Pump.....	.05
301814	8	Gasket - Support Plate to Housing Screw.....	.025
301815	1	Push Button - Fuel Pump.....	.15
301819	4	Gasket - Nipple.....	.025
301820	4	Nipple20
301821	1	Hose	4.95
301822	4	Hose Clamp025
301824	2	O - Ring - Seal - Fuel Connector.....	.10
301828	2	Retainer - Seal Ring - Fuel Connector.....	.10
301829	1	Spring - Lock - Fuel Connector.....	.025
301830	1	Lock - Fuel Connector.....	.15
301832	1	Rivet - Lock - Fuel Connector.....	.025
301835	1	Gasket - Filler Cap.....	.05
301837	1	Screw - Filler Cap.....	.05
301846	1	Jet - Slow Speed - Carburetor.....	.55
301847	2	Gasket - Bypass Cover.....	.05
301848	2	Cover - Bypass.....	.35
301849	1	Cover - Exhaust - Inner.....	.90
301852	1	Name Plate30
301853	1	Gasket - Inner to Outer Exhaust Cover.....	.15
301854	1	Gasket - Inner Exhaust Cover to Cylinder.....	.15
301855	1	Wave Washer - Armature Plate Support.....	.60
301857	2	Retaining Washer - Outer - Seal Spring.....	.05
301858	2	Screw - Leaf Attaching.....	.05
301859	1	Retaining Ring - Seal Spring.....	.15
301860	2	Retaining Washer - Inner Seal Ring.....	.05
301861	2	Spring - Seal.....	.05
301862	1	Gasket - Cylinder Head.....	.35
301863	1	Bracket - Port - Shroud and Starter Mounting.....	.90
301864	1	Bracket - Star - Shroud and Starter Mounting.....	.65
301877	2	O - Ring - Lower Shift Rod Seal and Slow Speed Needle Valve - Carburetor.....	.10
301878	1	Bushing - Shift Rod - Lower.....	.10
301884	1	Thrust Washer - Propeller Shaft.....	.60
301892	1	Thrust Washer - Swivel Bracket.....	.30
301893	1	Lining - Swivel Bracket.....	1.05
301895	1	Rod - Reverse Lock.....	.40
301896	1	Bolt - Thrust Socket.....	.40
301897	1	Lockplate - Stern Bracket.....	.15
301898	1	Spring - Reverse Lock.....	.20
301899	2	Rubber Bushing - Driveshaft Casing.....	.20
301900	1	Spacer - Rubber Bushing.....	.35
301902	1	Pin - Shift Lever to Shaft.....	.05
301903	1	Lever - Shift Rod.....	.45
301908	1	Valve - Exhaust Relief.....	.20
301909	1	Bushing - Shift Rod - Upper.....	.10
301910	1	Shift Rod - Upper.....	1.00
301911	1	Pin - Shift Rod.....	.15
301912	3	Cotter Pin - Clevis - Cross Shaft Pin - Yoke to Pin.....	.025
301913	1	Sleeve - Shift Rod.....	.10
301914	1	Spring - Shift Rod.....	.10
301915	1	Sleeve - Reverse Lock.....	.35
301916	1	Spring - Exhaust Relief Valve.....	.05
301917	1	O - Ring - Water Pump Seal.....	.35
301919	1	Cover - Exhaust - Outer.....	1.10
301920	1	Extension - Clamping Bar.....	.20
301921	1	Clamping Lever40
301923	1	Drive Pin05
301929	1	Screw - Upper Pump Housing to Driveshaft Casing.....	.10
301939	1	Cover - Upper Pump Housing.....	1.55
301947	1	Gasket - Exhaust Tube.....	.10

Order All Parts from Nearest Service Station or Dealer

Be Sure to Specify Model and Serial Number of Motor When Ordering Parts

PART No. 301949 TO PART No. 302063 INCL.

Part No.	No. Required per Motor	NAME OF PART	List Price per Piece
301949	2	Nut - Upper Shift Rod - Clevis to Shift Lever Link.....	.05
301953	1	Spring Washer - Steering Handle to Bracket.....	.10
301954	1	Washer - Steering Bracket to Handle.....	.10
301955	1	Screw - Steering Bracket to Handle.....	.15
301964	1	Screw - Exhaust Tube to Upper Pump Housing.....	.15
301965	2	Leaf - Carburetor.....	1.30
301966	1	Clampscrew - Upper Pump Housing.....	.15
301967	2	O - Ring - Carbon Seal to Crankshaft.....	.10
301974	2	Cotter Pin - Reverse Rod Lock.....	.025
301983	2	Conical Washer - Tilting Shaft.....	.20
301984	1	Bolt - Tilting Shaft.....	1.00
301987	1	Steering Handle.....	.95
301988	1	Nut - Crankshaft.....	.05
301992	4	Stud - Name Plate.....	.025
301995	1	Washer - Slow Speed Venturi.....	.025
301996	1	Washer - Float Valve.....	.025
301998	1	Washer - Float Chamber Plug.....	.025
301999	1	Gasket - Float Chamber to Carburetor Body Boss.....	.025
302001	2	Screw - Spark Plug Cover.....	.15
302003	1	Plunger - Primer - Carburetor.....	.20
302004	1	Nozzle - High Speed.....	.50
302006	1	Screw - Float - Carburetor to Carburetor Boss.....	.55
302007	2	Screw - Shroud - Port to Star.....	.05
302008	1	Screw - Shroud Handle Star to Port.....	.10
302009	10	Screw - Cylinder Head.....	.05
302011	1	Screw - Float Chamber.....	.15
302012	1	Hinge Pin - Float Arm.....	.20
302015	1	E - Ring - Slow Speed Needle Valve.....	.05
302017	1	Stud - Crankcase to Cylinder.....	.05
302018	1	Stud - Carburetor to Cylinder.....	.05
302019	1	Stud - Crankcase to Cylinder.....	.05
302024	1	Throttle Valve - Carburetor.....	.025
302025	2	Adjusting Knob - Slow and High Speed Needle Valves.....	.40
302026	1	Needle Valve - Slow Speed.....	.55
302027	1	Spring - Slow Speed Needle Valve.....	.05
302029	1	Needle Valve - High Speed.....	.55
302031	1	Leaf Valve - Crankcase Drain.....	.65
302032	1	Gasket - Leaf Valve Cover.....	.025
302033	1	Cover - Leaf Valve.....	.20
302034	1	Plate - Leaf Valve.....	.025
302035	2	O - Ring - Upper and Lower Bearing Seal.....	.20
302036	2	Seal - Upper and Lower Bearing.....	.55
302038	1	Pin - Clevis to Extension Lever.....	.15
302039	1	Clevis - Extension Lever to Link.....	.35
302040	1	Link - Clevis to Shift Lever.....	.50
302042	1	Check Valve - Air Line - Carburetor.....	.10
302043	1	Gasket - Float Chamber to Carburetor Body.....	.025
302044	1	Gasket - Leaf Plate to Crankcase.....	.10
302045	1	Gasket - Leaf Plate to Carburetor.....	.10
302046	2	Spacer - Check Valve Spring - Carburetor.....	.025
302047	2	Leaf - Stop.....	.20
302048	1	Spring - Check Valve - Carburetor.....	.025
302049	1	Leaf Plate.....	4.95
302050	1	Steering Bracket.....	4.95
302051	1	Spring - Tilting Shaft.....	.65
302052	1	Venturi - Carburetor.....	.50
302057	1	Cover - Spark Plug.....	.40
302060	1	Retainer - Gasoline Filter.....	.05
302061	1	Wing Nut - Gasoline Filter.....	.05
302062	1	Filter - Gasoline Filter.....	.65
302063	1	Stud - Gasoline Filter.....	.15

Order All Parts from Nearest Service Station or Dealer

Be Sure to Specify Model and Serial Number of Motor When Ordering Parts

PART No. 302064 TO PART No. 302498 INCL.

Part No.	No. Required per Motor	NAME OF PART	List Price per Piece
302064	1	Bowl - Gasoline Filter.....	.30
302065	1	Gasket - Gasoline Filter.....	.05
302067	1	Body - Gasoline Filter.....	.95
302068	1	Arm - Control Shaft - Carburetor.....	.30
302069	1	Arm - High Speed Needle Valve - Carburetor.....	.35
302070	1	Bracket - Control Shaft.....	.35
302071	1	Spring - Throttle Link - Carburetor.....	.05
302072	1	Link - Throttle Lever to Cross Shaft Lever.....	.05
302076	1	Link - High Speed Needle Valve.....	.55
302077	1	Screw - Bell Crank Primer.....	.10
302078	1	Bell Crank - Primer - Carburetor.....	.20
302079	1	Control Shaft - Carburetor.....	.55
302084	1	Link - Steering Bracket to Carburetor.....	.15
302086	1	Cam Lever - Carburetor.....	.35
302088	1	Spring - Cross Shaft.....	.60
302091	1	Spring - Steering Bracket Link.....	.20
302094	1	Groove Pin - Steering Bracket.....	.025
302102	1	Lever - Steering Bracket.....	.35
302103	1	Nut - Spindle Screw.....	.025
302104	3	Screw - Retainer.....	.025
302105	1	Screw - Valve to Throttle Shaft.....	.025
302130	1	Groove Pin - Control Shaft.....	.025
302135	2	Spring - Pressure Relief.....	.05
302136	2	Valve - Pressure Relief.....	.05
302137	2	Washer - Pressure Relief.....	.025
302157	1	Transfer - Shifting.....	N/C
302158	1	Transfer - Timing - Port.....	N/C
302159	1	Transfer - Timing - Star.....	N/C
302162	1	Spring - Plunger - Carburetor.....	.10
302186	2	Washer - Retaining Spark Plug Cover Screw.....	.025
302191	1	Cover - Upper Pump Housing (QDL).....	3.05
302194	1	Shift Rod - Upper - (QDL).....	1.10
302222	1	Friction Spring - Starter.....	.40
302232	1	Gasket - Flange to Power Head.....	.05
302233	2	Washer - Throttle Lock.....	.05
302234	1	Spring - Throttle Lock.....	.025
302235	1	Plug - Bypass - Lower.....	.35
302290	3	Washer - Exhaust Tube to Upper Pump Housing.....	.025
302376	2	Lockwasher - Shroud - Port to Star - Front and Rear.....	.025
302380	2	Washer - Spark Plug Cover to Shroud Screw.....	.025
302381	1	Cotter Pin - Propeller Nut.....	.025
302404	4	Bracket - Shroud Mounting.....	.40
302405	8	Grommet - Shroud Mounting.....	.10
302406	4	Spacer - Shroud Mounting.....	.05
302407	4	Washer - Large - Shroud Mounting.....	.05
302408	4	Screw - Shroud Mounting.....	.05
302416	2	Screw - Exhaust Tube to Upper Pump Housing.....	.05
302420	2	Retainer - Swivel Plate.....	.025
302423	1	Exhaust Tube.....	3.60
302428	2	Screw - Support - Rubber Mounting.....	.10
302440	1	Cam - Armature Plate.....	1.10
302441	1	Support - Armature Plate.....	.40
302442	1	Retaining Ring - Armature Plate Support.....	.60
302468	3	Screw - Ratchet to Dome.....	.05
302473	1	Bow Washer - Link to Shift Lever.....	.025
302474	1	Washer - Link to Shift Lever.....	.025
302483	1	Propeller Shaft.....	10.25
302489	1	Impeller Housing.....	2.50
302490	1	Plate - Impeller Housing - Water Pump.....	.40
302491	1	Driveshaft.....	10.00
302493	1	O - Ring - Gearcase Head.....	.20
302495	1	Seal - Propeller Shaft.....	1.10
302496	1	Bearing - Gear - Front.....	2.10
302497	1	Grommet - Water Tube - Upper.....	.10
302498	1	Grommet - Water Inlet Tube - Upper.....	.025

Order All Parts from Nearest Service Station or Dealer

Be Sure to Specify Model and Serial Number of Motor When Ordering Parts

PART No. 302499 TO PART No. 375646 INCL.

Part No.	No. Required per Motor	NAME OF PART	List Price per Piece
302499	2	Needle Bearing Assembly - Upper and Lower Journal.....	5.80
302500	1	Cradle.....	.50
302501	1	Pivot Pin - Shifting Lever.....	.025
302504	1	Pin - Yoke to Shift Rod.....	.025
302505	1	Cover - Water Bypass.....	.10
302508	4	Screw - Impeller Housing to Upper Gearcase.....	.05
302509	2	Screw - Water Bypass Cover.....	.05
302510	4	Screw - Upper Gearcase Housing to Pump Housing.....	.10
302512	1	Driveshaft - (QDL).....	12.25
302513	1	Seal - Upper to Lower Gearcase.....	.05
302514	1	Link - Shift Rod.....	.45
302515	1	Shift Rod - Lower.....	.75
302518	1	Locking Lever - Reverse.....	2.00
302519	1	Thrust Socket.....	.70
302555	1	Housing - Lower - Gas Tank.....	1.75
302556	1	Support Plate - Gasoline Tank.....	1.10
302557	1	Gasket - Gasoline Tank.....	.50
302559	1	Float - Gasoline Tank.....	.15
302560	1	Plate - Filler Cap.....	.025
302561	1	Push Rod - Fuel Pump.....	.05
302563	1	Diaphragm - Fuel Pump.....	.45
302568	1	Glass - Gasoline Tank.....	.30
302570	1	Handle - Gasoline Tank.....	.85
302571	1	Seal - Gasoline Tank Glass.....	.025
302572	1	Housing - Upper - Gasoline Tank.....	4.25
302653	1	Pin - Indicator to Lower Housing.....	.025
302654	2	Snap Ring - Indicator Pin.....	.025
302757	1	Screen - Water Intake.....	.30
302771	1	Spring - High Tension Leads (QD-12) (Use 302827 QD-13)	.35
302827	1	Spring - High Tension Leads (QD-13).....	.25
302847	1	Transfer - Oiling.....	N/C
302848	2	Transfer - Sea Horse 10 - Port and Star.....	Net .10
302849	1	Transfer - Port.....	Net .35
302850	1	Transfer - Starting.....	N/C
302852	1	Transfer - Star.....	Net .35
303562	1	Spring - Swivel Bracket.....	.10
303067	1	O-Ring - Driveshaft to Crankshaft.....	.10
375295	2	Terminal - Ignition Leads.....	.10
375542	1	Handle - Starter Rope.....	.65
375587	1	Fuel Connector Assembly.....	4.95
375589	1	Body Assembly - Fuel Connector.....	1.65
375591	2	Piston and Dowel Pin Assembly.....	4.25
375594	1	Cylinder Head and Core Plug Assembly.....	4.00
375595	2	Connecting Rod Assembly.....	9.10
375597	1	Shaft and Lever Assembly.....	1.25
375599	1	Driveshaft Casing Assembly.....	9.90
375605	1	Propeller and Bushing Assembly.....	5.50
375613	1	Stern Bracket and Clampscrew Assembly - Port.....	2.75
375614	1	Stern Bracket and Clampscrew Assembly - Star (Order 376034).....	
375616	1	Float Chamber and Plug Assembly.....	4.35
375617	1	Cylinder and Crankcase Assembly.....	53.25
375619	1	Float and Arm Assembly.....	.85
375620	1	Starter Housing and Pin Assembly.....	3.05
375622	1	Filter Yoke and Thumb Ascrew Assembly.....	.45
375623	1	Filter Assembly.....	3.05
375626	1	Timing Lever and Handle Assembly.....	1.10
375627	1	Throttle Shaft, Lever and Pin Assembly.....	.85
375628	1	Venturi Assembly - Slow Speed.....	1.40
375629	1	Cross Shaft Arm and Pin Assembly.....	.45
375631	1	Cross Shaft, Lever and Pin Assembly.....	.85
375633	1	Shift Lever and Knob Assembly.....	2.20
375634	1	Throttle Lock Assembly - Steering Bracket.....	1.05
375635	1	Swivel Bracket and Screw Assembly.....	4.35
375638	1	Impeller Assembly - Water Pump.....	1.10
375645	1	Shroud Cover and Transfer Assembly - Port.....	10.50
375646	1	Shroud Cover and Transfer Assembly - Star.....	11.00

Order All Parts from Nearest Service Station or Dealer

Be Sure to Specify Model and Serial Number of Motor When Ordering Parts

PART No. 375652 TO PART No. 590646 INCL.

Part No.	No. Required per Motor	NAME OF PART	List Price per Piece
375652	1	Driveshaft Casing Assembly (QDL).....	11.50
375654	1	Float Valve and Seat Assembly.....	1.45
375668	1	Piston, Connecting Rod Assembly with Rings, less Bearings (upper)	15.50
375670	1	Carburetor Assembly Complete.....	36.00
375673	1	Tool Kit Assembly.....Net	1.00
375674	1	Oil Line Assembly.....	.55
375675	1	Gas Line - Filter to Fuel Connector.....	.45
375676	1	Air Line - Carburetor to Fuel Connector.....	.55
375677	1	Gas Line - Carburetor to Filter.....	.55
375680	1	Carburetor Body, Valve and Venturi Assembly.....	11.75
375681	1	Starter Assembly Complete.....	15.25
375683	1	Float Bowl and Float Assembly.....	12.50
375685	1	Water Tube Assembly (QDL).....	1.10
375711	1	Shifter Assembly - Clutch Dog.....	3.60
375716	4	Mounting Bracket Assembly - Shroud.....	.95
375719	2	Rubber Mounting - Power Head to Lower Unit.....	.95
375730	1	Piston, Connecting Rod Assembly with Rings, less Bearings (lower)	15.50
375735	1	Crankshaft Assembly.....	29.00
375742	2	Clamp Screw Assembly with Plate and Retainer.....	.95
375751	1	Gear Housing Head and Bearing Assembly.....	3.15
375755	1	Shifter Lever and Pin Assembly.....	.50
375774	1	Gas Tank Assembly.....	22.00
375777	1	Gasoline Tank Assembly Complete.....	44.00
375778	1	Indicator Assembly.....	1.50
375784	1	Gear Housing, Bearings and Pin Assembly.....	27.50
375817	1	Filler Cap Assembly.....	1.25
375844	1	Pinion, Gear and Bushing Assembly.....	22.00
375846	1	Foot Valve Assembly Complete.....	2.00
375847	1	Water Tube Assembly.....	1.00
375852	1	Pump Housing and Bushing Assembly.....	7.50
375853	1	Pump Housing and Bushing Assembly (QDL).....	8.50
375935	1	Retainer and O - Ring Assembly.....	.75
376034	1	Stern Bracket, Lockplate and Bolt Assembly.....	3.50
510126*	3	Washer - Insulating - Stop Switch.....	.025
510168	1	Cam - Magneto.....	.25
510173	2	Condenser.....	.90
510185	2	Eccentric Screw - Breaker Base Assembly.....	.10
510188	1	Oiler Clip.....	.05
510189	1	Oiler Wick.....	.025
510190	1	Clamp - High Tension Lead Mounting.....	.025
510191	2	Screw - Coil and Lamination Mounting - Armature Plate Mounting.....	.025
510192	2	Screw - Armature Plate Mounting.....	.025
510193	4	Screw - Condenser Mounting - Lead Clamp.....	.025
510194	2	Screw - Terminal to Breaker Assembly.....	.025
510195*	5	Screw - Coil and Lamination Mounting (*Stop Switch).....	.025
510204	2	Spring Clip - Breaker Spring.....	.05
510208	2	Bow Washer - Breaker Base Mounting.....	.025
510218	1	Clamp - High Tension Lead Mounting.....	.10
580118	2	Coil and Lamination Assembly.....	7.50
580120	1	Armature Plate Assembly.....	28.25
580121	1	Armature Plate and Post Assembly.....	3.50
580122	2	Breaker Base Assembly.....	.55
580123	2	Breaker Arm Assembly Complete.....	1.00
580126*	1	Lead Assembly - Breaker to Stop Switch - Long.....	.30
580127*	1	Lead Assembly - Breaker to Stop Switch - Short.....	.15
580134	1	High Tension Lead Assembly - Short.....	.60
580135	1	High Tension Lead Assembly - Long.....	.60
580148	2	Breaker Assembly - Complete.....	1.65
580155	1	Flywheel Assembly.....	17.50
590646	1	Starter Pulley Assembly.....	2.50

*Note —Parts used only on Model QD-12 Motors below Serial Number 876796.

Order All Parts from Nearest Service Station or Dealer

